

Refuelling

Fuel type: Unleaded petrol only

Fuel octane number: Your motorcycle is designed to use Research Octane Number (RON) 90 or higher.

Tank capacity: 3.7 litres (0.98 US gal, 0.81 Imp gal)

Refuelling and Fuel Guidelines ➔ P. 14

Opening the Fuel Fill Cap

- 1 Open the seat. ➔ P. 33
- 2 Turn the fuel fill cap counterclockwise until it stops and remove the cap.

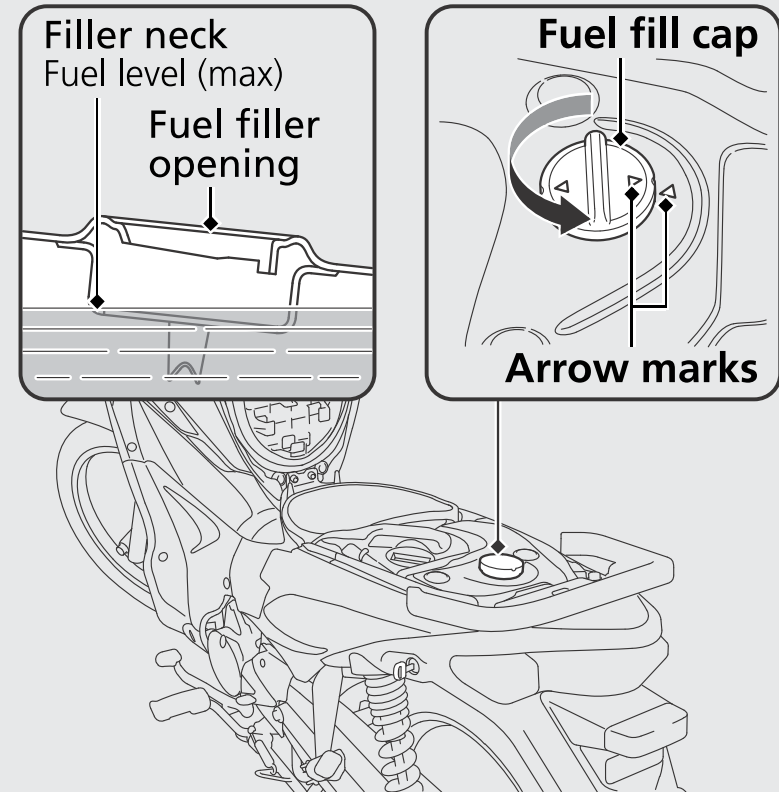

Do not fill with fuel above the filler neck.