

Front Turn Signal Bulb

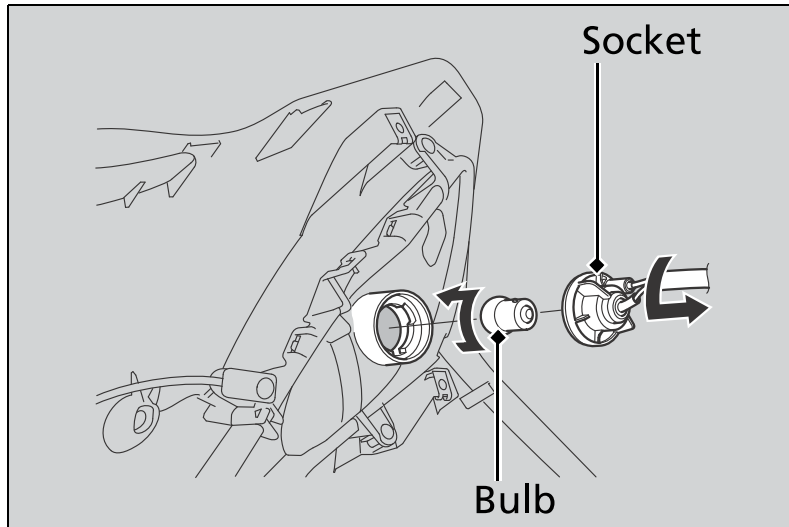

1. Remove the front top cover. ► P. 53
2. Turn the socket counterclockwise and pull it out.
3. Slightly press the bulb and turn it counterclockwise.
4. Install a new bulb in the reverse order of removal.
 - Use only the amber bulb.

Rear Turn Signal Bulb

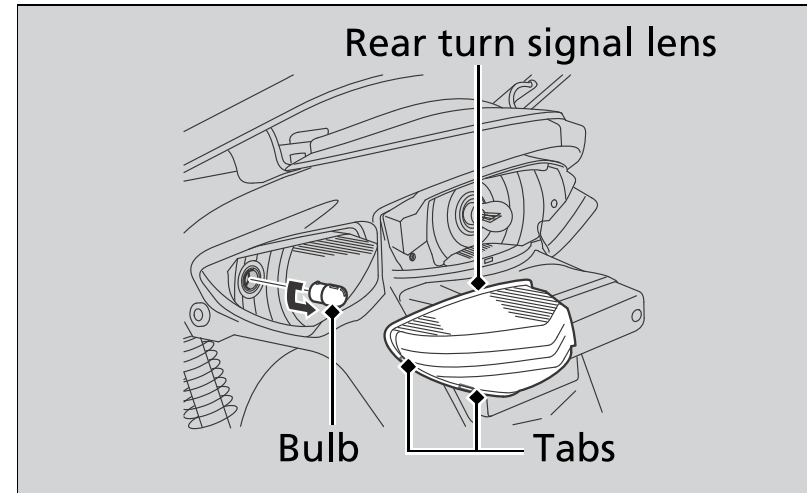

1. Remove the brake/tail light lens. ► P. 88
2. Remove the rear turn signal lens by releasing the tabs.
3. Slightly press the bulb in and turn it counterclockwise.
4. Install a new bulb and parts in the reverse order of removal.
 - Use only the amber bulb.
 - After putting back the lens packing in place, install the rear turn signal lens.