

Fuse Box:

The fuse box (1) is located near the battery.
The specified fuse is:

10A

1. Open the seat (page 39).
2. Remove the battery cover and starter magnetic switch cover (page 97).
3. Open the fuse box cover (2).
4. Pull out the fuse (3). If the fuse is blown, install a new fuse.
The spare fuse (4) is located on reverse side of the battery cover (5).
5. Close the fuse box cover.
6. Install the battery cover and starter magnetic switch cover.
7. Close the seat.

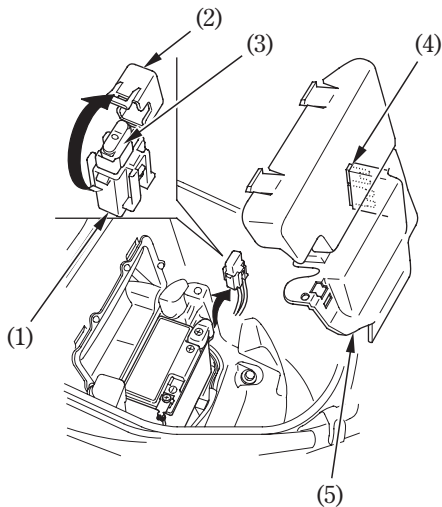

- (1) Fuse box
- (2) Fuse box cover
- (3) Fuse
- (4) Spare fuse
- (5) Battery cover