

Inspection

The reserve tank is located under the right side of the crankcase.

Check the coolant level in the reserve tank (1) while the engine is at the normal operating temperature with the motorcycle in an upright position. If the coolant level is below the LOWER level mark (2), remove the screw (3). Pull out the prong (4) from the hole (5). Remove the cover (6) and reserver tank cap (7). Add coolant mixture until it reaches the UPPER level mark (8). Always add coolant to the reserve tank. Do not attempt to add coolant by removing the radiator cap.

If the reserve tank is empty, or if coolant loss is excessive, check for leaks and see your dealer for repair.

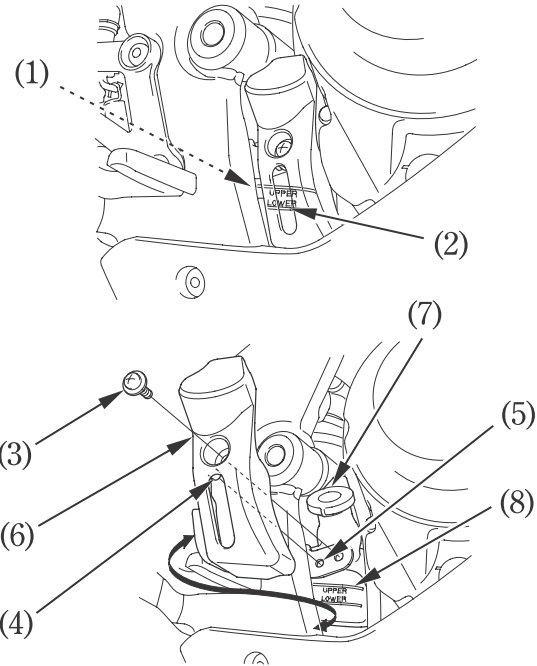

- | | |
|----------------------|-----------------------|
| (1) Reserve tank | (5) Hole |
| (2) LOWER level mark | (6) Cover |
| (3) Screw | (7) Reserver tank cap |
| (4) Prong | (8) UPPER level mark |