

Clip A

The clip A must be removed to remove the left inner panel, left side cover, left fairing pocket and left middle cowl.

Removal

1. Press down on the centre pin to release the lock.
2. Pull the clip out of the hole.

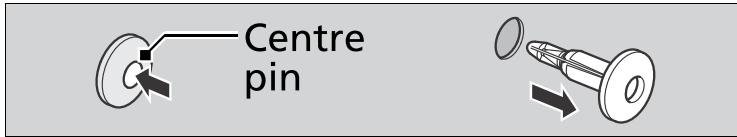

Installation

1. Push the bottom of the centre pin.
2. Insert the clip into the hole.
3. Press down on the centre pin to lock the clip.

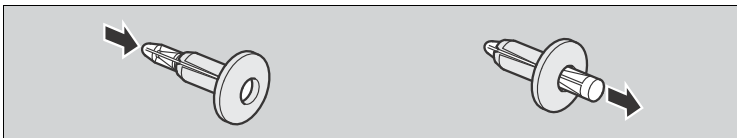

Clip B

The clip B must be removed to remove the left side cover.

Removal

1. Pull the pin to release the lock.
2. Pull the clip out of the hole.



Installation

1. Insert the clip into the hole.
2. Press down on the pin to lock the clip.

