

# Refuelling

This motorcycle must be opened the rear seat for refuelling.

Operation Guide

## Rear Seat

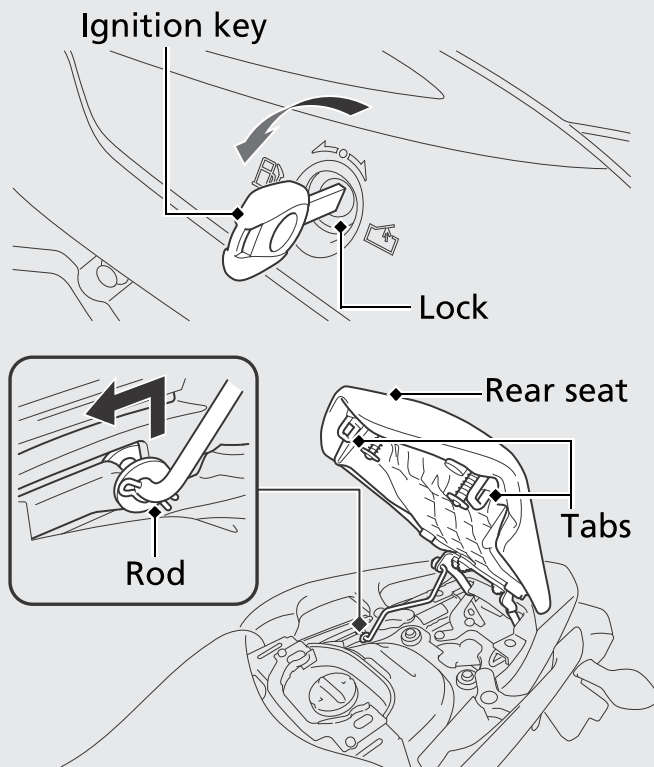

### Open

- 1 Insert the ignition key into the lock, and turn the key counterclockwise.
- 2 Pull up the front of the rear seat.

### Close

- 1 Pull up the rod upward.
- 2 Push down the front of the rear seat until it locks in place.
  - ▶ Make sure that the tabs are locked securely in position to pull up the front of the rear seat lightly.
  - ▶ The seat locks automatically when closed. Take care not to lock your key in the compartment under the rear seat.
- 3 Remove the key.