



Clutch System

Upper Adjustment

Minor adjustments are generally made with the upper clutch cable adjuster.

LEFT HANDLEBAR

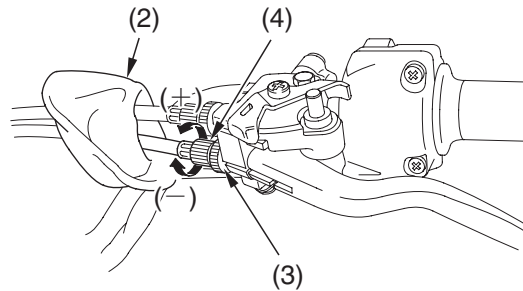

- | | |
|---------------------------------|-----------------------|
| (2) dust cover | (+) increase freeplay |
| (3) upper lock nut | (-) decrease freeplay |
| (4) upper clutch cable adjuster | |

1. Pull back the dust cover (2).
2. Loosen the upper lock nut (3).
3. Turn the upper clutch cable adjuster (4) to obtain the specified freeplay.
4. Tighten the lock nut and check the freeplay again.
5. Pull on the dust cover.

If proper adjustment cannot be obtained or the clutch does not work correctly, the cable or clutch friction discs may be worn. See your Honda dealer.