



Controls & Features

Front Brake Lever

The front brake lever (1) is used to slow or stop your ATV. To operate, pull the lever. For information on braking techniques, see page 63 .

Rear Brake Lever

The rear brake lever/parking brake lever (2) is used to slow or stop your ATV. To operate, pull the lever. For information on braking techniques, see page 63 .

LEFT & RIGHT HANDLEBAR

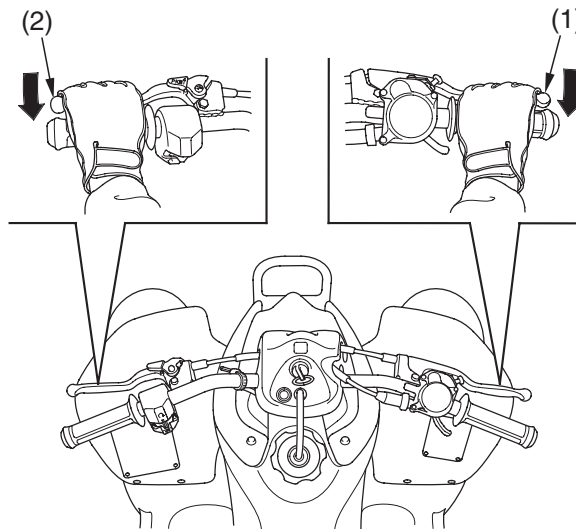

- (1) front brake lever
- (2) rear brake lever/parking brake lever

24 Indicator & Controls

