

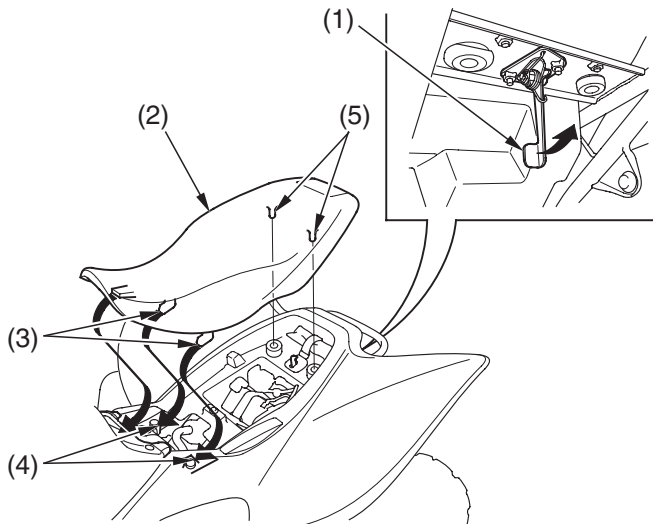

Seat Removal

Refer to *Safety Precautions* on page 84 .

The seat must be removed for air cleaner, battery and fuse maintenance.



- (1) seat lock lever
- (2) seat
- (3) front prongs

- (4) hooks
- (5) studs

Removal

1. Pull the seat lock lever (1) up behind the seat.
2. Slide the seat (2) back and lift it.

Installation

1. Insert the front prongs (3) into the hooks (4) on the frame and press the studs (5) into the grommets on the storage compartment.
2. Press down on the seat until it locks.