

Installation:

1. Position the battery.
2. Connect the positive (+) terminal lead to the battery first.
3. Remove the left side cover (page 48).
4. Check the negative (-) terminal lead (4) runs under the tool box (7), and is tucked up behind the guide tab (8).
5. Connect the negative (-) terminal lead to the battery.
6. Install the removed parts in the reverse order of removal.

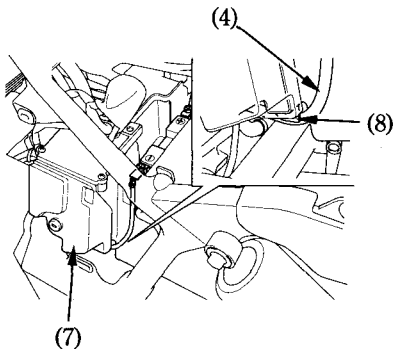

- (4) Negative (-) terminal lead
- (7) Tool box
- (8) Guide tab