



Controls & Features

Ignition Switch

The ignition switch (1) is used for starting and stopping the engine (page 41) and to lock the steering for theft prevention (page 51). Insert the key and turn it to the right for the ON position. Push down on the key and turn it to the left to the LOCK (steering lock) position.

Key Position	Function
ON	Electrical circuits on.
OFF	No electrical circuits function.
LOCK (steering lock)	No electrical circuits function. Locks the steering head.

FRONT

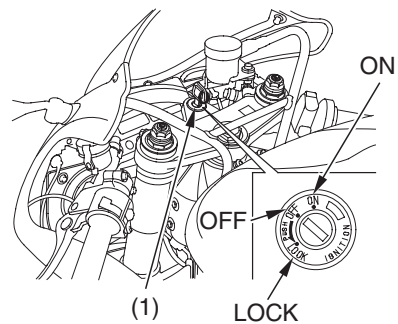

(1) ignition switch

To unlock the steering lock, insert the key and turn it to the right to the OFF position.

