

# Controls & Features

## Ignition Switch

The ignition switch (1) is used for starting and stopping the engine (page 45 ). The ignition key is also used to lock the steering for theft prevention (page 54 ). Insert the key and turn it to the right for the ON position.

Key Position	Function
ON	Electrical circuits on.
OFF	No electrical circuits function.

LEFT SIDE

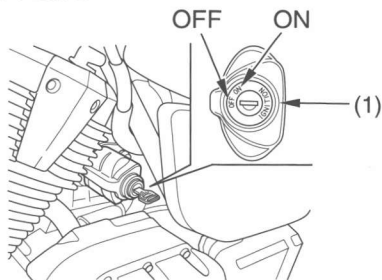

(1) ignition switch

If a key ring is used, we recommend a fabric or leather type with just the key attached. The use of a metal key ring or the attachment of additional keys to any type of key ring may damage the finish of the side cover and engine cover while inserting the key or riding.