

## Service and maintenance

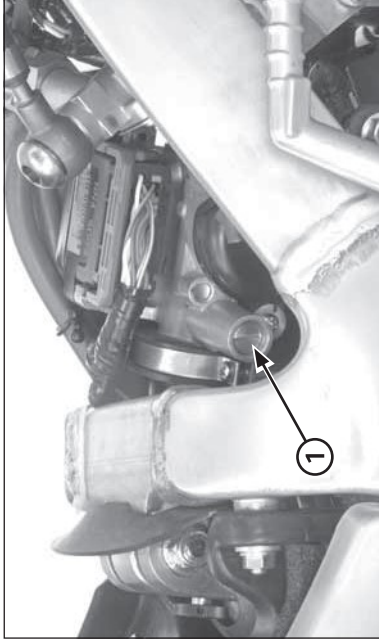

(1) THROTTLE STOP SCREW

### Engine Idle Speed

Inspect and adjust the idle speed after all other engine adjustments are within specification. The engine must be warm for an accurate idle inspection and adjustment.

Warm up the engine until the fan starts, shift the transmission into neutral, and hold the motorcycle upright position. Connect a tachometer according to its manufacturer's operating instruction.

**Idle speed: 1,800 ± 100 min-1 (rpm)**

### NOTICE

*An improper idling speed will cause starting problems.*

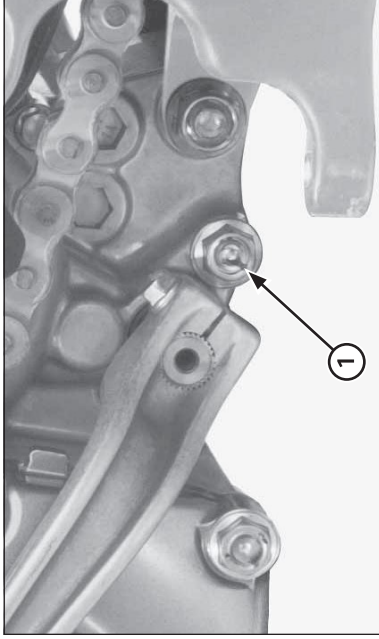

(1) DRAIN BOLT

### Transmission Oil

#### Oil Change

- Transmission oil should be changed at least every six competitions to ensure consistent performance and maximum service life of both transmission and clutch components.
- Warm-up the engine before draining the oil. This will ensure complete and rapid draining.

Remove the bolts and skid plate.

1. Support the motorcycle in an upright position on level surface.
2. Remove the oil filler cap from the clutch cover.
3. Place an oil drain pan under the engine to catch the oil, then remove the drain bolt and sealing washer from the left crankcase.
4. After the oil has drained completely, install the drain bolt with a new sealing washer. Tighten the drain bolt to the specified torque.

**Torque: 22 N•m (2.2 kgf•m, 16 lbf•ft)**

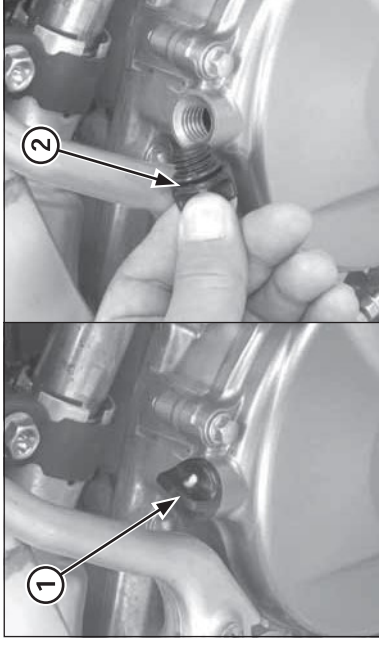

(1) FILLER CAP  
(2) O-RING

5. Pour specified transmission oil.

**Specified transmission oil: ELF HTX 740 (75W)**

**Capacity: 0.54 liter (0.57 US qt, 0.48 Imp qt) after draining  
0.57 liter (0.60 US qt, 0.50 Imp qt) after  
disassembly**

Check the O-ring is in good condition, install the oil filler cap.