

(1) BOLTS  
(2) CAM CHAIN GUIDE PLATE

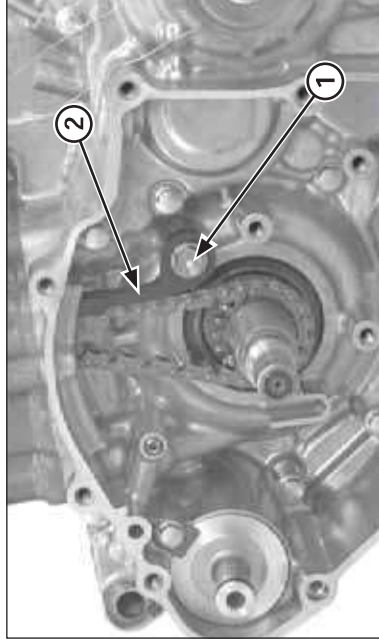

(1) BOLT  
(2) CAM CHAIN TENSIONER

Remove the following:

- Cylinder head (page 4-23)
- Left crankcase cover (page 4-49)
- Flywheel (page 4-52)

Remove the bolts and cam chain guide plate.

Remove the bolt, cam chain tensioner, pivot collar and washer.

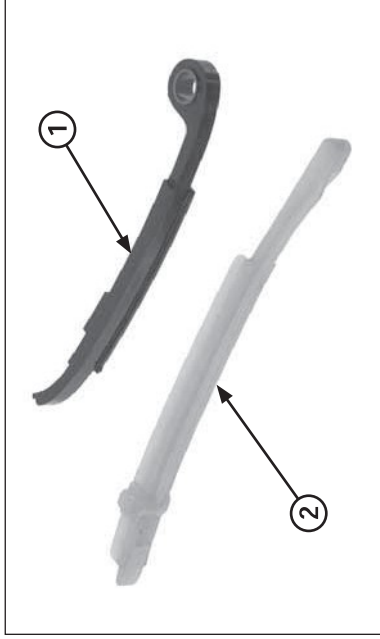

(1) CAM CHAIN TENSIONER  
(2) CAM CHAIN GUIDE

**Inspection**

Inspect the cam chain tensioner and cam chain guide for excessive wear or damage, replace if necessary.

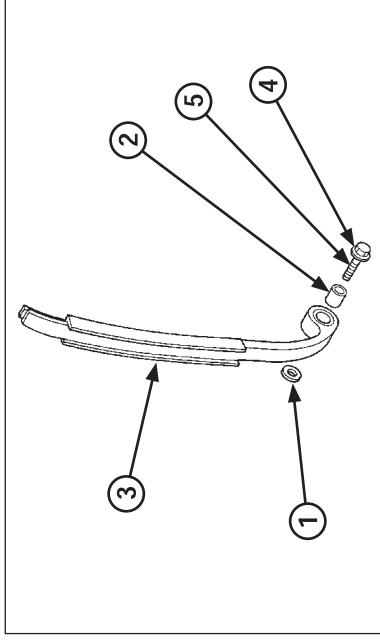

(1) WASHER (2) PIVOT COLLAR  
(3) CAM CHAIN TENSIONER  
(4) PIVOT BOLT (5) APPLY LOCKING AGENT

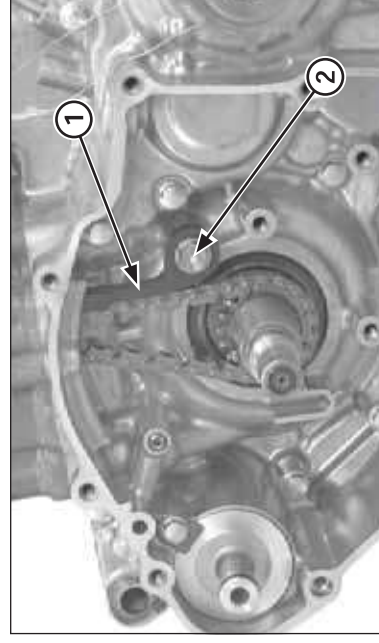

(1) CAM CHAIN TENSIONER  
(2) PIVOT BOLT

**Installation**

Apply a locking agent to the cam chain tensioner pivot bolt thread.

Install the washer, cam chain tensioner, pivot collar and pivot bolt.

Tighten the pivot bolt to the specified torque.

**Torque: 12 N•m (1.2 kgf•m, 9 lbf•ft)**