

# Refuelling

**Fuel type:** Unleaded petrol only

**Fuel octane number:** Your scooter is designed to use Research Octane Number (RON) 91 or higher.

**Tank capacity:** 4.0 litres (1.06 US gal, 0.88 Imp gal)

**Refuelling and Fuel Guidelines** ➔ P. 9

## Opening the Fuel Fill Cap

- 1 Open the seat. ➔ P. 36
- 2 Turn the fuel fill cap counterclockwise until it stops and remove the cap.

Lower edge of filler neck

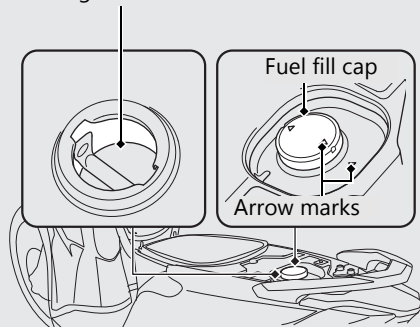

Do not fill with fuel above the lower edge of the filler neck.