

## Switches (Continued)

### Steering Lock

Lock the steering when parking to help prevent theft. A U-shaped wheel lock or similar device is also recommended.

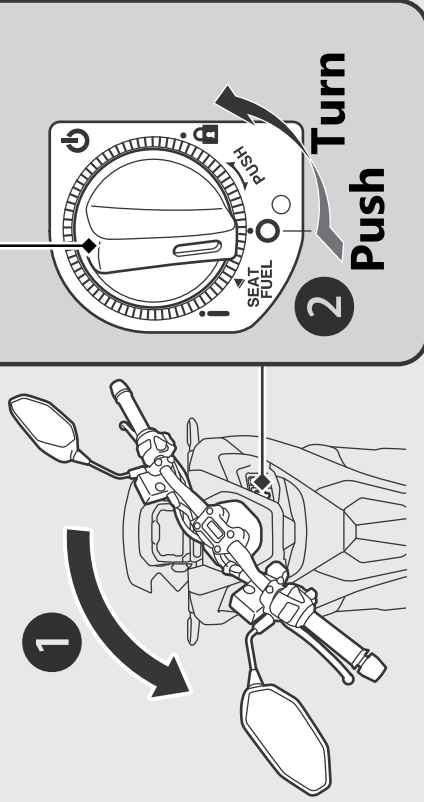

### Locking

- 1 Turn the handlebar all the way to the left or right.
- 2 Push the ignition switch down, and turn it to the **Lock** position.
  - ▶ To unlock the ignition switch **▶P.34**
  - ▶ Jiggle the handlebar if the lock is difficult to engage.
- 3 Lock the ignition switch.

### Unlocking

- Push the ignition switch in, and turn it to the **Off** position.
- ▶ To unlock the ignition switch **▶P.34**