

Front Suspension Spring Pre-load

Refer to *Safety Precautions* on page 78 .

FRONT

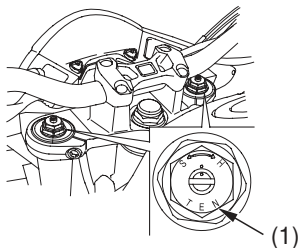

(1) pre-load adjuster

Adjust the spring pre-load by turning the pre-load adjuster (1).

To adjust to the standard position:

1. Turn the spring pre-load adjuster counterclockwise until it will no longer turn (lightly seats). This is the full soft setting.
2. Turn the adjuster clockwise 8 turns. This is the standard position.
3. Make sure that both fork legs are adjusted to the same position.

To Reduce Spring Pre-load (SOFT):

For a light load and smooth road conditions, turn the adjuster counterclockwise toward SOFT.

To Increase Spring Pre-load (HARD):

For a firmer ride and rough road conditions, turn the adjuster clockwise toward HARD.