

## Front/Rear Turn Signal/Position Light Bulb

1. Remove the screw.
2. Remove the turn signal/position light lens and lens packing.
3. Slightly press the bulb and turn it counterclockwise.

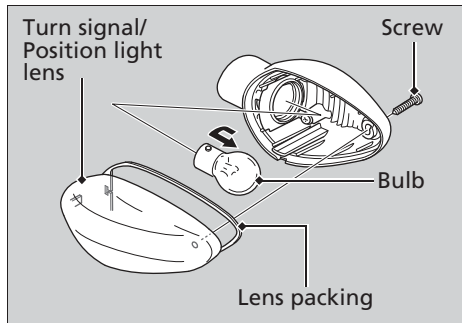

4. Install a new bulb and reinstall the parts in the reverse order of removal.

## License Plate Light Bulb

1. Remove the screws, license light cover and license light cover packing.
2. Pull the bulb out of the socket without turning it.

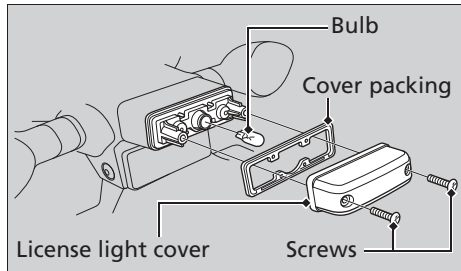

3. Install a new bulb and reinstall the parts in the reverse order of removal.