

## Changing Engine Oil

UNDER ENGINE

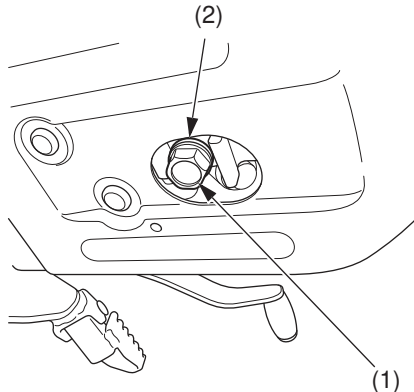

- (1) oil drain bolt
- (2) sealing washer

1. If the engine is cold, start it and let it idle for 3-5 minutes. Turn the engine off. Wait 2-3 minutes for the oil to settle.
2. Park your motorcycle on its side stand on a firm, level surface.
3. Place a drain pan under the crankcase.
4. To drain the oil, remove the oil fill cap/dipstick, oil drain bolt (1), and sealing washer (2).
5. Pour the drained oil into a suitable container and dispose of it in an approved manner (page 128).

### NOTICE

*Improper disposal of drained fluids is harmful to the environment.*

(cont'd)