

Intercom (I-COM) System

VOLUME Control

To select the Volume control, push the VOLUME knob/button until “INTERCOM VOL” is displayed (page 76). Then, within 5 seconds, change the volume control.

- To increase the volume — push the VOLUME lever up or turn the VOLUME knob/button clockwise.
- To decrease the volume — push the VOLUME lever down or turn the VOLUME knob/button counterclockwise.

To increase or decrease the volume rapidly — push the VOLUME lever up or down and hold it down.

(VOLUME level range : from 0 to 20)

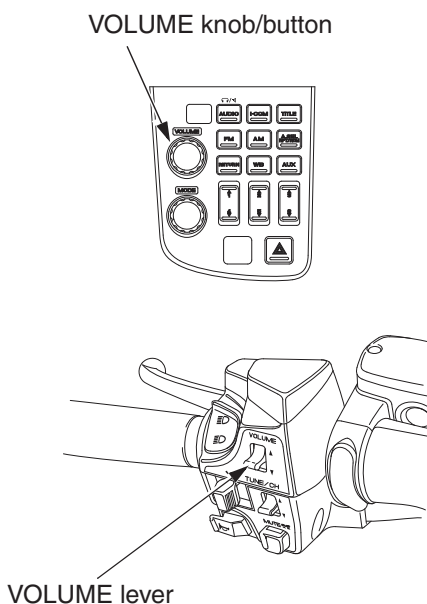

INTERCOM VOL

VOL 8