

# Crankcase Breather

Refer to *Safety Precautions* on [page 154](#).

Service the crankcase breather more frequently if your motorcycle is ridden in the rain or often at full throttle. Service the breather if you can see deposits in the transparent section of the drain tube.

If the drain tube overflows, the air filter may become contaminated with engine oil causing poor engine performance.

## Draining

### LEFT SIDE

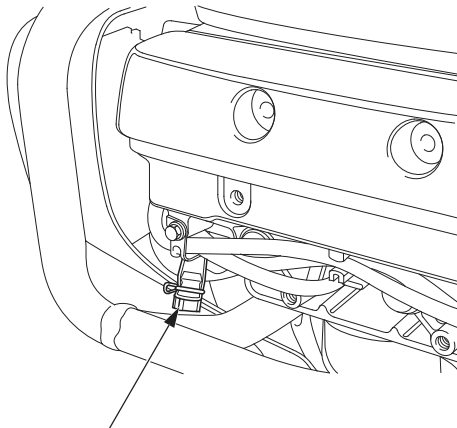

crankcase breather tube plug

1. Remove the left cylinder head side cover ([page 169](#)).
2. Place a drain pan under the crankcase breather tube plug.
3. Remove the plug to drain the deposits in the tube.
4. Reinstall the crankcase breather tube plug.
5. Reinstall the left cylinder head side cover.