

Refueling

This motorcycle's rear seat must be opened for refueling.

Rear Seat

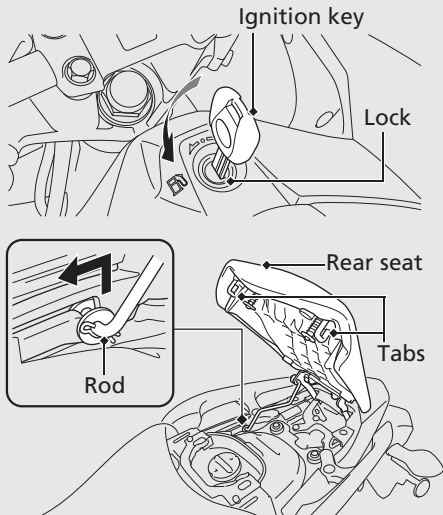

Open

- Insert the ignition key into the lock, and turn the key counterclockwise.
- Pull up the front of the rear seat.

Close

- Pull the rod upward.
 - ▶ Make sure that the tabs are locked securely in position by pulling up lightly on the front of the rear seat.
 - ▶ The seat locks automatically when closed. Take care not to lock your key in the compartment under the rear seat.
- Remove the key.