

# Starting & Stopping the Engine

## Starting Procedure

To restart a warm engine, follow the procedure for “*High Air Temperature.*”

The starter motor will operate only when the transmission is in neutral.

Normal Air Temperature 10° – 35°C (50° – 95°F)

### LEFT HANDLEBAR

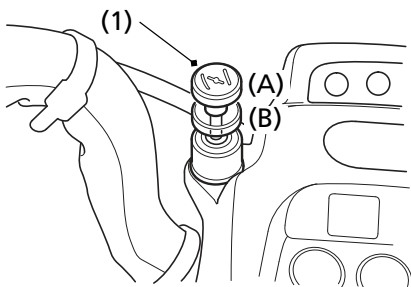

(1) choke knob

(A) fully ON

(B) fully OFF

1. Pull the choke knob (1) up all the way to fully ON (A).
  2. With the throttle slightly open, press the start button.
- Pressing the electric start button for more than 5 seconds at a time may cause the starter to overheat and damage the starter. Release the start button for approximately 10 seconds before pressing it again.