

If a Fuse Blows

EPS (Electric Power Steering) Fuse Access (TRX420FM2 only)

1. Turn the ignition switch to OFF (w) before checking the fuse.
2. Remove the seat (page 114).
3. Remove the rear fender cover (page 117).
4. To access the EPS fuse (1), remove the EPS fuse box cover (2).
If the EPS fuse is blown, see your dealer for this service.
5. Install the EPS fuse box cover.
6. Install the rear fender cover.
7. Install the seat.

UNDER REAR FENDER COVER

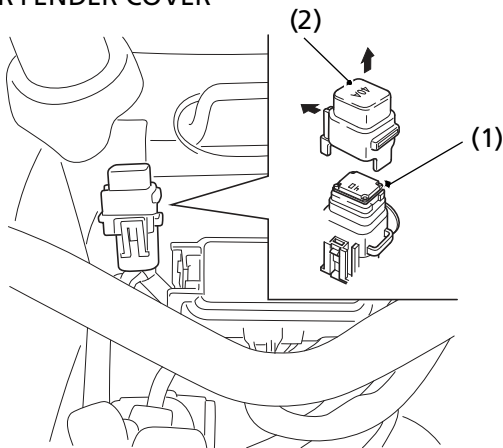

(1) EPS fuse

(2) EPS fuse box cover