

Tool Kit

The tool kit (1) and the gear change tool (2) are stored in the storage compartment (page 58).

After using the tool kit or the gear change tool, be sure to use the rubber band (3) to fasten the tool kit and the gear change tool securely.

An optional, larger tool kit may be available. Check with your dealer's parts department.

REAR

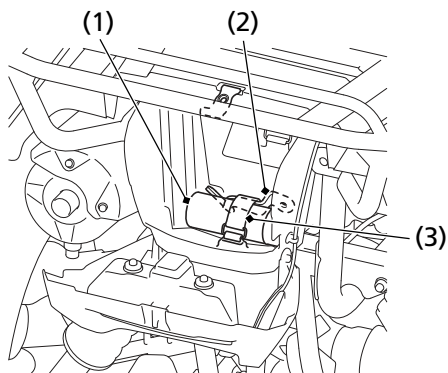

(1) tool kit

(2) gear change tool

(3) rubber band