

# Controls & Features

---

## Front Brake Lever

The front brake lever (1) is used to slow or stop your ATV. To operate, pull the lever. For information on braking techniques, see page 63.

## Rear Brake Lever/Parking Brake Lever

The rear brake lever/parking brake lever (2) is used to slow or stop your ATV. To operate, pull the lever. For information on braking techniques, see page 63.

### LEFT & RIGHT HANDLEBAR

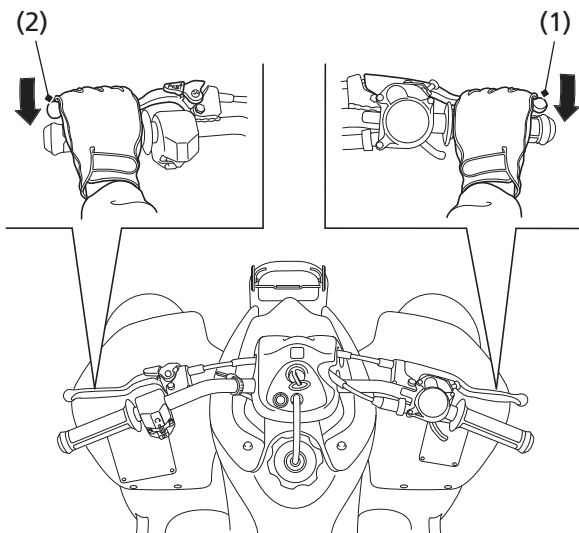

(1) front brake lever

(2) rear brake lever/parking brake lever