

Main Fuse (VT750C2/C2F/C2B)

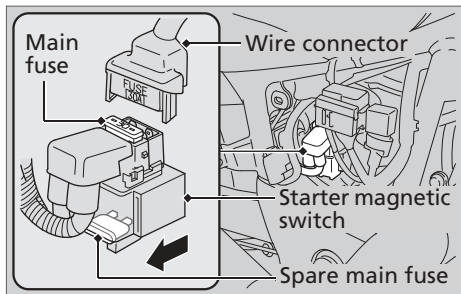

1. Remove the right side cover. ► P. 50
2. Disconnect the wire connector of the starter magnetic switch.
3. Pull the main fuses out and check for a blown fuse. Always replace a blown fuse with a spare of the same rating.
► Spare main fuse is located under the starter magnetic switch.
4. Reinstall parts in the reverse order of removal.