

## Storage Equipment *(Continued)*

### Helmet holder

The helmet holder is on the left side below the seat.

A helmet set wire is in the tool kit. **➔ P.29**

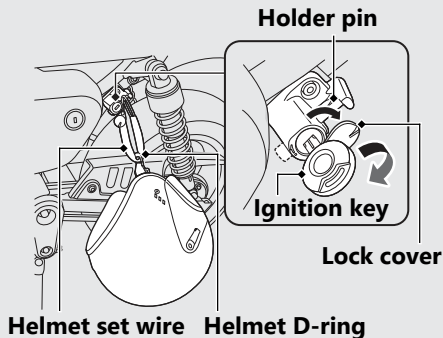

### Unlocking

Open the lock cover, insert the ignition key and turn it clockwise.

### Locking

- 1 Hang both ends of the helmet set wire that has been passed through the helmet D-ring on the holder pin and push it in to lock.
- 2 Remove the key and close the lock cover.
  - ▶ Use the helmet holder only when parked.

## **⚠ WARNING**

Riding with a helmet attached to the holder can interfere with the rear wheel or suspension and could cause a crash in which you can be seriously hurt or killed.

Use the helmet holder only while parked. Do not ride with a helmet secured by the holder.