

F-3 Steering stem · Front fender

F-3 Steering stem · Front fender

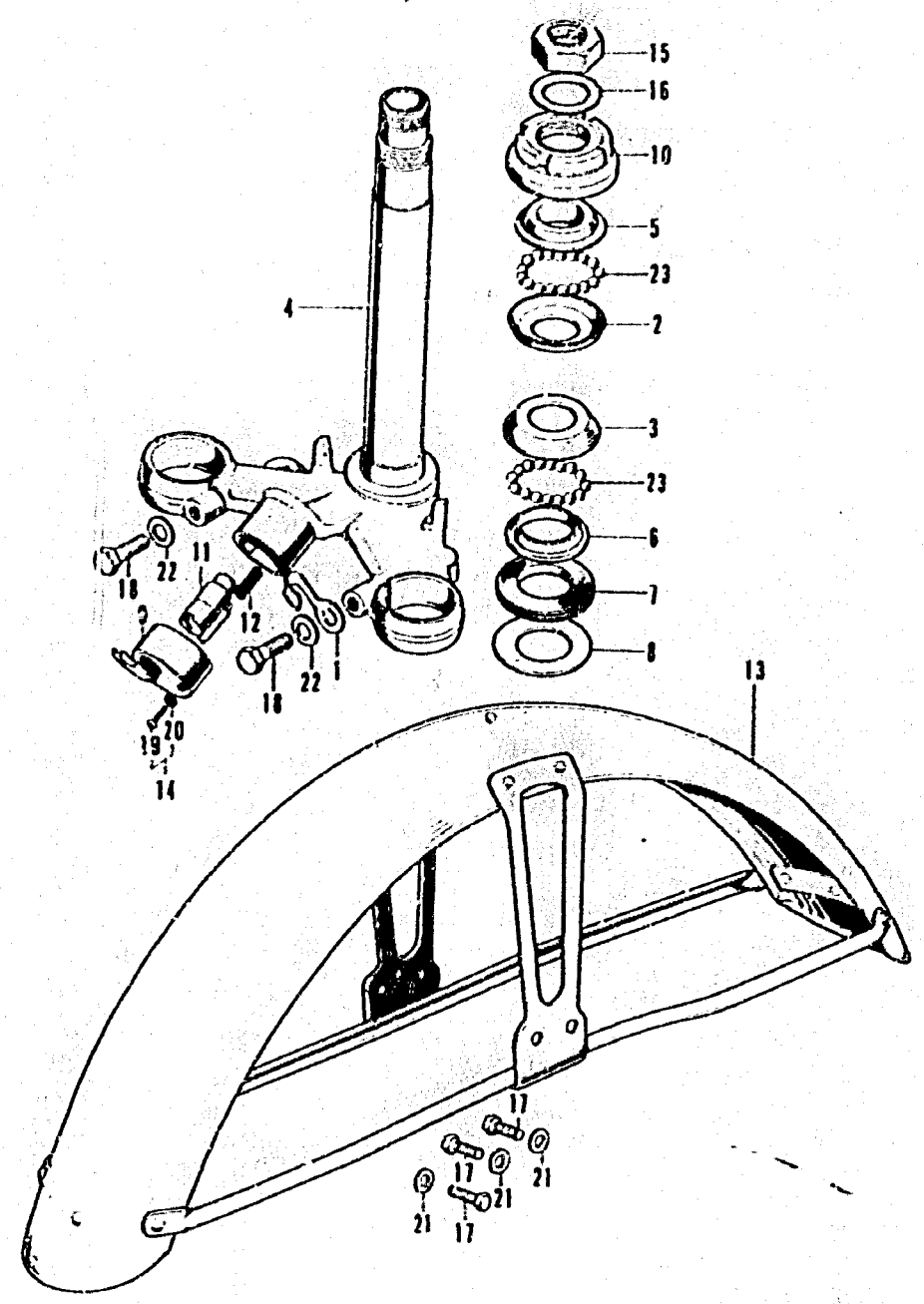

Ref. No.	Part No.	Description	Reqd. No. CB125K5	Serial No.	Area code
1	45465-028-000	CLIP; FR. BRAKE CABLE	1		
2	50301-200-315	RACE; STEERING TOP BALL	1		
3	50302-200-305	RACE; STEERING BOTTOM BALL	1	5021590	
	50301-268-305	RACE; STEERING TOP BALL	1	5021591	
4	53200-338-000B	STEM COMP.; STEERING	1		DK, DM, F
	53200-342-730B	STEM COMP.; STEERING	1		ED, G
5	53211-200-305	RACE; SIFERING TOP CONE	1		
6	53212-200-305	RACE; STEERING BOTTOM CONE	1		
7	53214-200-000	DUST SEAL; STEERING HEAD	1		
8	53215-200-000	WASHER; STEERING HEAD DUST SEAL	1		
9	53215-317-000	COVER COMP.; HANDLE LOCK CASE	1		DK, DM, F
10	53220-303-000	THREAD COMP.; STEERING HEAD TOP	1		
11	53600-051-000	LOCK COMP.; STEERING HANDLE	1		ED, G
	53600-230-000	LOCK COMP.; STEERING HANDLE (TOYO)	1		DK, DM, F
	53600-303-007	LOCK COMP.; STEERING HANDLE (HONDA LOCK)	1		DK, DM, F
12	53631-268-020	SPRING; HANDLE LOCK	1		DK, DM, F
13	61100-315-000XV	FENDER COMP.; FR.	1		
14	90109-342-000	SCREW WASHER; 3X8	1	5021591	
15	90304-240-000	NUT; STEERING STEM	1	5044799	DK, DM, F, G, ED
	95020-11200	NUT A2; STEERING STEM	1	5044800	DK, DM, F, G
16	90503-222-000	WASHER; STEERING STEM	1		
17	92000-06016	BOLT; HEX.; 6X16	3	5021590	
	93481-06016	BOLT-WASHER; 6X16	3	5021591	
19	92000-08030-0A	BOLT; HEX.; 8X30	2	5021590	
	92000-08032-0A	BOLT; HEX.; 8X32	2	5021591	
19	93500-03008-0A	SCREW; PAN; 3X8	1	5021590	
20	94101-03000	WASHER; PLAIN; 3MM	1	5021590	
21	94101-06000	WASHER; PLAIN; 6MM	3	5021590	
22	94102-08000	WASHER; PLAIN; 8MM	2		
23	96211-08000	BALL; STEEL; #8 (1/4)	36		

B315-23A