

F-6 Fuel tank • Fuel cock

D 13

F-6 Fuel tank • Fuel cock

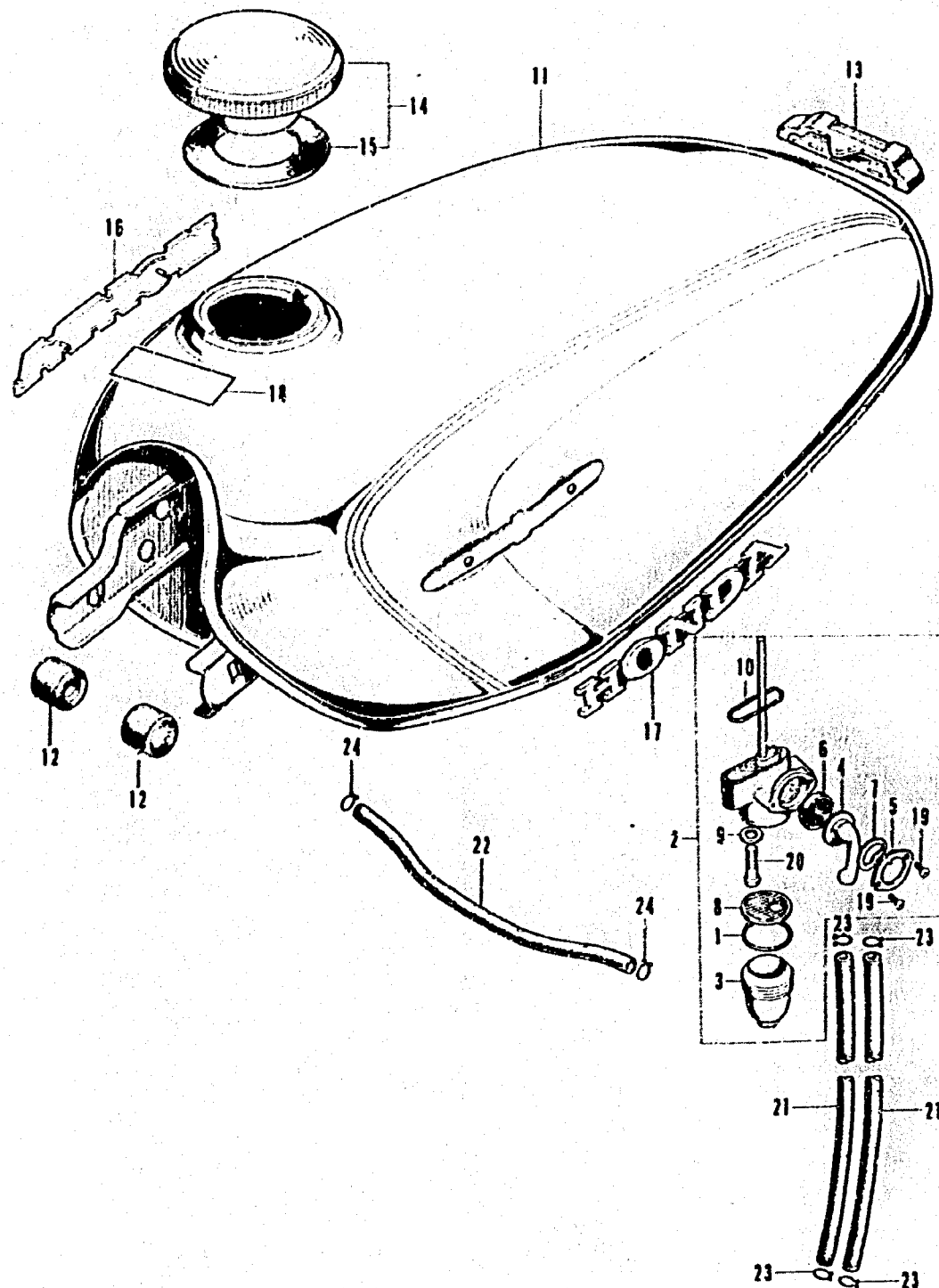

Ref. No.	Part No.	Description	Reqd. No. CB125K5	Serial No.	Area code
1	16173-001-004	PACKING; FUEL STRAINER CUP	1		
2	16950-336-005	COCK ASSY.; FUEL	1		
3	16952-028-000	CUP; FUEL STRAINER	1		
4	16953-028-004	LEVER; FUEL COCK	1		
5	16954-028-000	PLATE; COCK LEVER SETTING	1		
6	16955-028-004	GASKET; COCK LEVER	1		
7	16956-028-004	SPRING; COCK LEVER	1		
8	16957-028-000	SCREEN; FUEL STRAINER	1		
9	16993-011-000	GASKET; COCK FIXING	1		
10	16997-273-000	O-RING; 23MM	1		
11	17500-336-000K	TANK COMP.; FUEL	1		
	17500-336-000M	TANK COMP.; FUEL	1		
	17500-336-000Z	TANK COMP.; FUEL	1		DK, DM, ED
12	17611-303-000	PAD; FUEL TANK FR.	2		
13	17613-336-000	CUSHION; FUEL TANK RR.	1		
14	17620-292-020	CAP; FUEL FILLER	1		
15	17631-259-000	GASKET; FUEL FILLER CAP	1		
16	87121-336-000	EMBLEM; R. FUEL TANK	1		
17	87122-336-000	EMBLEM; L. FUEL TANK	1		
18	87560-323-611A	MARK; DRIVE CAUTION	1		G
	87560-323-611B	MARK; DRIVE CAUTION	1		G
	87560-323-621A	MARK; DRIVE CAUTION	1		F
	87560-323-621B	MARK; DRIVE CAUTION	1		F
	87560-323-670A	MARK; DRIVE CAUTION	1		DK, DM, ED
	87560-323-670B	MARK; DRIVE CAUTION	1		DK, DM, ED
19	93500-03006-0A	SCREW; PAN; 3X6	2		
20	93500-06016	SCREW; PAN; 6X16	1		
21	95001-45200-40	TUBE; FUEL; 4.5X200	2		
22	95001-55200-40	TUBE; FUEL; 5.3X200	1		
23	95002-02080	CLIP B8; TUBE	4		
24	95002-02100	CLIP B10; TUBE	2		

B315-63