

F-10 Rear fender • Tool box

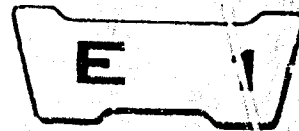

F-10 Rear fender • Tool box

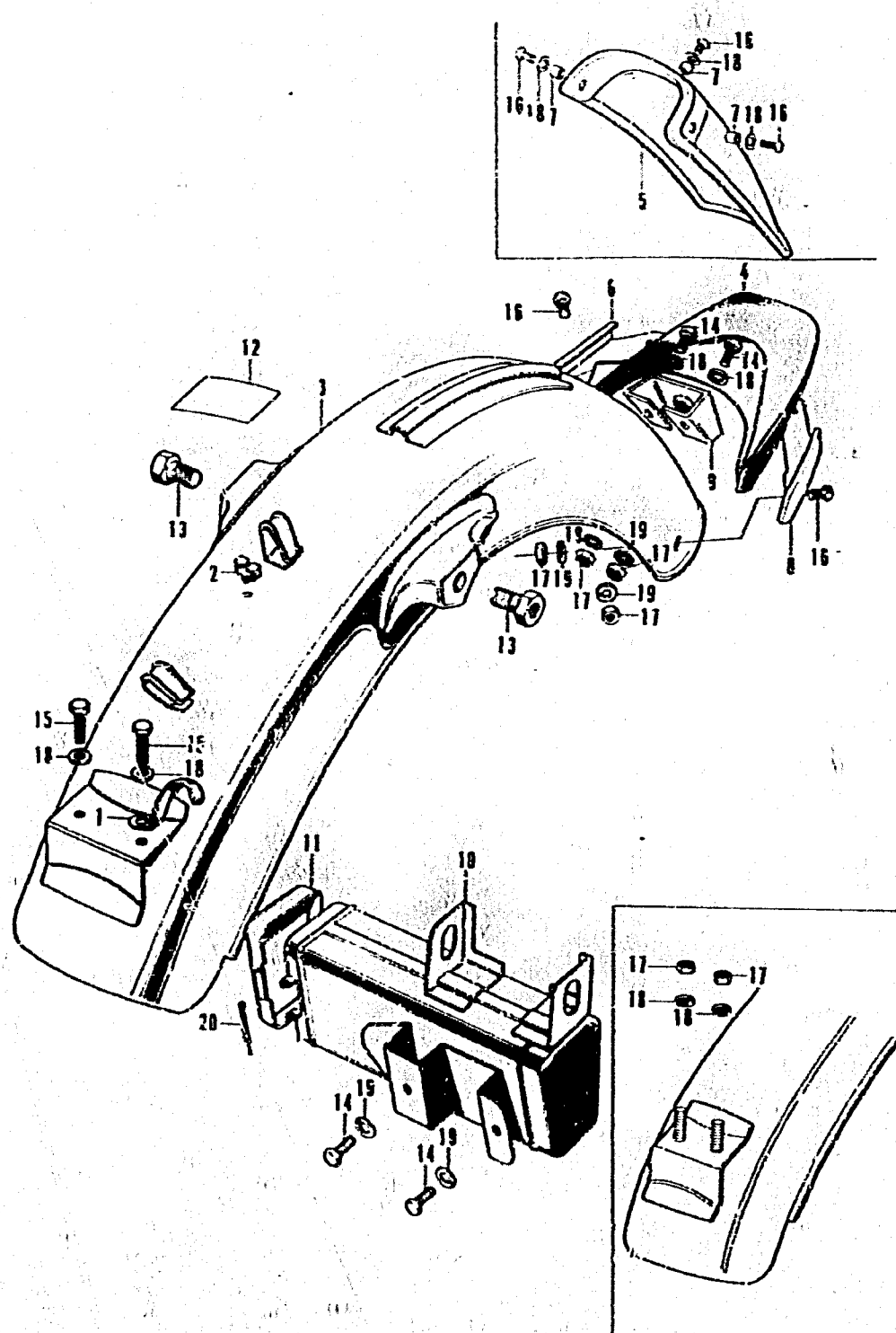

Ref. No.	Part No.	Description	Reqd. No. CB125K5	Serial No.	Area code
1	32172-336-000	CLIP, WIRE HARNESS	1		
2	32915-300-000	GROMMET, WIRE CORD	1		DK,DM,ED,F
3	80100-304-610XW	FENDER COMP., RR.	1		G
	80100-336-620XV	FENDER COMP., RR.	1		F
	80100-336-730XV	FENDER COMP., RR.	1		ED
	80100-338-000XV	FENDER COMP., RR.	1		DK,DM
4	80121-216-000	MUDGUARD, RR. FENDER	1		DK,DM,F
5	80121-315-731	MUDGUARD, RR. FENDER	1		ED
6	80122-216-010	STAY, R. RR. FENDER MUDGUARD	1		DK,DM,F
7	80122-315-730	COLLAR, MUDGUARD SETTING	3		ED
8	80123-216-010	STAY, L. RR. FENDER MUDGUARD	1		DK,DM,F
9	80134-216-620	STAY, REFLEX REFLECTOR	1		F
10	83500-306-000B	BOX COMP., TOOL	1		
11	83541-286-000B	CAP, TOOL BOX	1		
12	87506-336-680	MARK, BATTERY CAUTION	1		
13	90162-303-000	BOLT, RR. FENDER SETTING	2	5021590	
	90162-351-000	BOLT, RR. FENDER SETTING	2	5021591	
14	92000-06012	BOLT, HEX., 6X12	4	5021590	F,DK,DM,ED,G
			2	5021591	F
	93481-06012-00	BOLT-WASHER, 6X12	2	5021591	F
15	92000-06014	BOLT, HEX., 6X14	2	5021636	
16	93500-06020-49	SCREW, PAN, 6X20	2		DK,DM,F
			3		ED
17	94001-06000	NUT, HEX., 6MM	2	5021636	DK,DM
			3	5021636	ED
			4	5021636	F
			4	5021637	DK,DM
			5	5021637	ED
			6	5021637	F
			2	5021637	G
18	94101-06000	WASHER, PLAIN, 6MM	2		DK,DM,G
			4		ED
			5	5021590	F
			2	5021591	F
19	94111-06000	WASHER, SPRING, 6MM	4		DK,DM
			5		ED
			6		F
			2		G
20	94201-20350	PIN, SPLIT, 2.0X35	1		

8336-31