

F-16 Frame body

E 8

F-16 Frame body

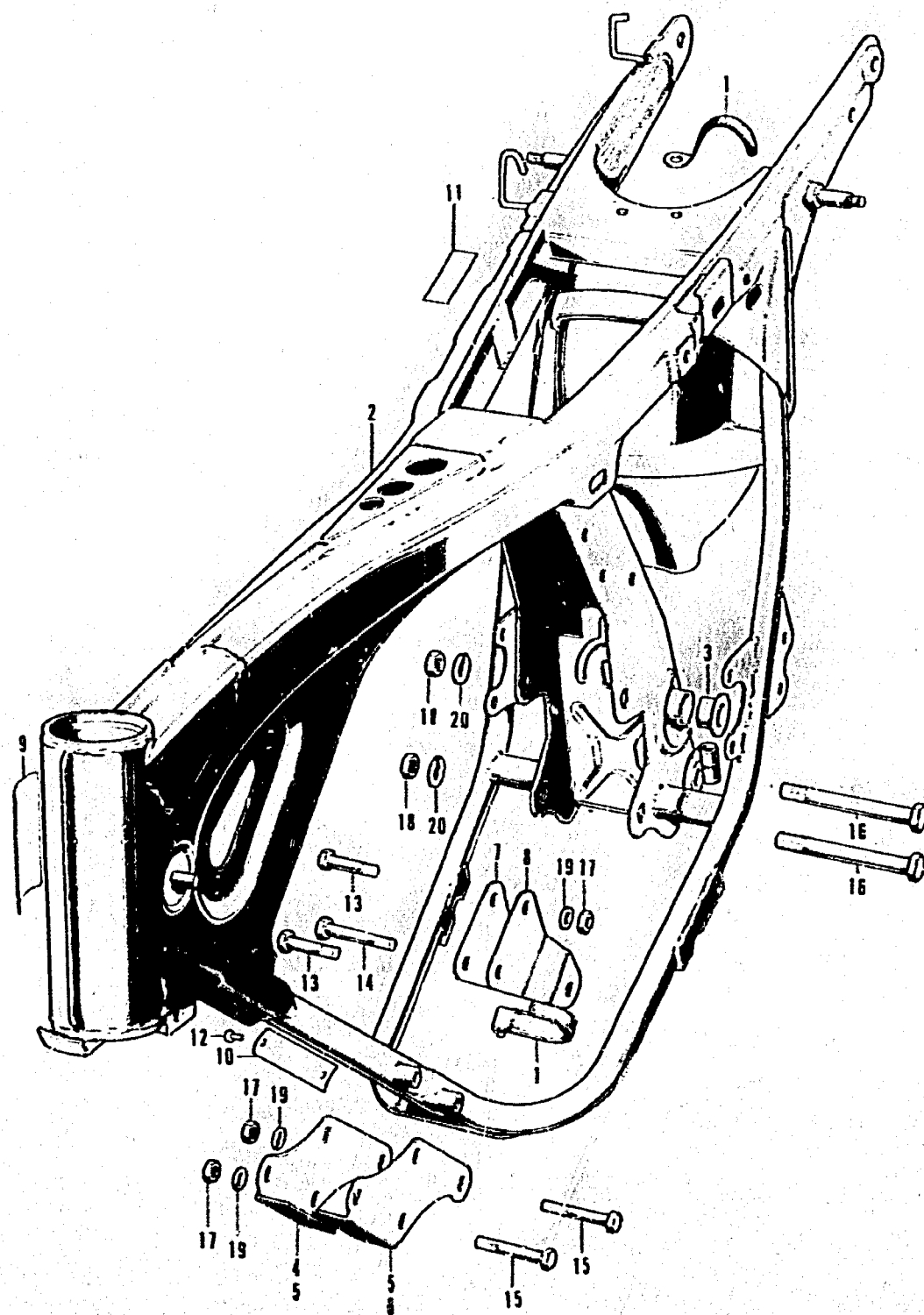

Ref. No.	Part No.	Description	Reqd. No. CB125K5	Serial No.	Area code
1	32172-336-000	CLIP, WIRE HARNESS	2		
2	50100-336-0108	BODY COMP., FRAME	1		DK, DM
	50100-336-6108	BODY COMP., FRAME	1		G
	50100-336-6208	BODY COMP., FRAME	1		F
	50100-336-7308	BODY COMP., FRAME	1		ED
3	50157-303-000	WUSH, CENTER PIPE	2		
4	50352-303-0108	PLATE, R. FR. ENGINE HANGER	1	5021590	
5	50352-351-000	PLATE, FR. ENGINE HANGER	2	5021591	
6	50353-303-0108	PLATE, L. FR. ENGIN HANGER 50352-351-000	1	5021590	
7	50354-303-000	PLATE, R. ENGINE UPPER HANGER	1		
8	50355-303-000	PLATE, L. ENGINE UPPER HANGER	1		
9	87125-041-680	PLATE, NAME	1		DK, DM
10	87501-336-610	PLATE, REGISTERED NUMBER	1		G
	87501-336-620	PLATE, REGISTERED NUMRER	1		F
	87501-336-730	PLATE, REGISTERED NUMBER	1		ED
11	87511-323-670	LABEL, HELMET HOLDER	2		
12	90841-001-000	SCREW, RIVET, 1.5X5	2		ED, F, G
13	92200-08040-0A	BOLT, HEX., 8X40	2	5021590	
	92000-08040-0A	BOLT, HEX., 8X40	2	5021591	
14	92200-08063-0A	BOLT, HEX., 3X63	1	5021590	
	92000-08063-0A	BOLT, HEX., 8X65	1	5021591	
15	92200-08080-0A	BOLT, HEX., 8X80	4	5021590	
	92000-08080-0A	BOLT, HEX., 8X80	4	5021591	
16	92200-10106-0A	BOLT, HEX., 10X106	2	5021590	
	92000-10106-0A	BOLT, HEX., 10X106	2	5021591	
17	94001-08000-0S	NUT, HEX., 8MM	7		
18	94001-10000-0S	NUT, HEX., 10MM	7		
19	94111-08000	WASHER, SPRING, 8MM	7		
20	94111-10000	WASHER, SPRING, 10MM	2		

E315-48A