

F-18-1 Headlight - Case (F)

E 11

F-18-1 Headlight - Case (F)

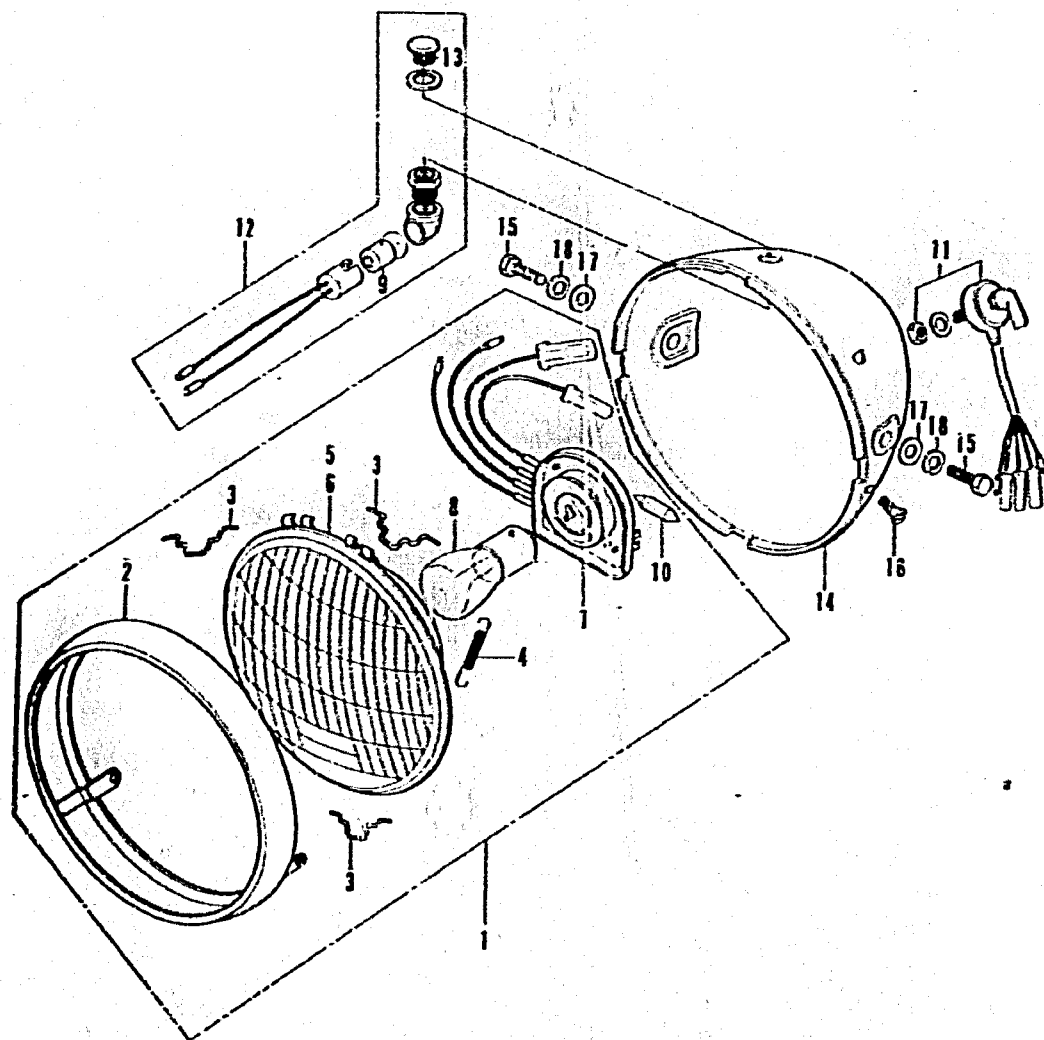

Ref. No.	Part No.	Description	Reqd. No. CB125K5	Serial No.	Area code
1	33100-246-622	HEADLIGHT ASSY. (6V 25/25W 4V)	1		F
2	33101-246-621	RIM, HEADLIGHT	1		F
3	33108-028-013	SPRING, UNIT HOLDER (STANLEY)	1		F
4	33115-283-601	SPRING, SOCKET HOLDER	1		F
5	33120-230-621	HEADLIGHT UNIT	1		F
6	33120-246-621	HEADLIGHT UNIT	1		F
7	33130-286-621	SOCKET ASSY., HEADLIGHT	1		F
8	34901-351-621	BULB, HEADLIGHT (LOCL PROCUREMENT PART)	1		F
9	34902-259-000	BULB, DASH (12V3.4V)	1		F
10	34903-382-621	BULB, POSITION (6V 4V) (LOCL PROCUREMENT PART)	1		F
11	35150-246-620	SWITCH ASSY., LIGHTING	1		F
12	37550-304-970	LAMP ASSY., BEAM PILOT	1		F
13	37551-044-670	LENS, BEAM PILOT	1		F
14	61301-336-610HX	CASE, HEADLIGHT 61301-329-610HX	1	5006223	F
	61301-336-610MU	CASE, HEADLIGHT 61301-329-610MU	1	5006223	F
	61301-329-610HX	CASE, HEADLIGHT	1	5006224	F
	61301-329-610MU	CASE, HEADLIGHT	1	5006224	F
15	92000-10020-C3	BOLT, HEX., 10X20	2		F
16	93700-05010-08	SCREW, DYAL, 5X10	2		F
17	94101-10000	WASHER, PLAIN, 10MM	2		F
18	94111-10000	WASHER, SPRING, 10MM	2		F

B336-34