

F-19 Winker(G)

E 13

F-19 Winker(G)

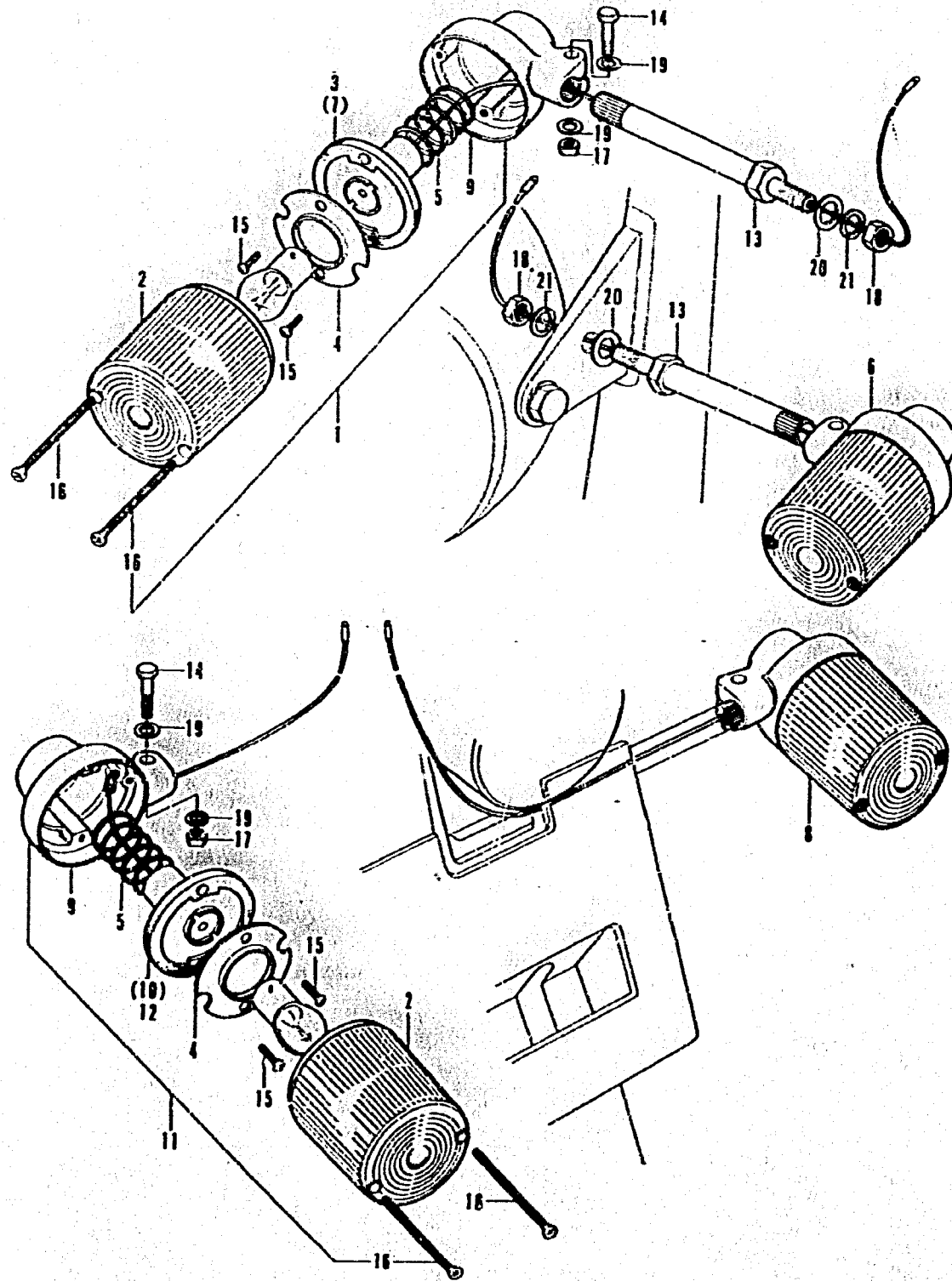

Ref. No.	Part No.	Description	Reqd. No. CBI25K5	Serial No.	Area code
1	33400-304-610	WINKER ASSY., R. FR.	1	5026200	G
	33400-304-611	WINKER ASSY., R. FR.	1	5026201	G
2	33402-268-610	LENS, FR. WINKER	4		G
3	33410-292-610	SOCKET ASSY., R. FR. WINKER	1		G
4	33411-285-000	RING, WINKER 33433-285-010	4	5026200	G
	33403-285-010	RING, WINKER	4	5026201	G
5	33413-285-000	SPRING, COIL	4		G
6	33450-304-610	WINKER ASSY., L. FR.	1	5026200	G
	33450-304-611	WINKER ASSY., L. FR.	1	5026201	G
7	33460-292-610	SOCKET ASSY., L. FR. WINKER	1		G
8	33600-304-610	WINKER ASSY., R. RR. 33600-304-611	1	5026200	G
	33600-304-611	WINKER ASSY., R. RR.	1	5026201	G
9	33605-292-610	BASE, WINKER	4		G
10	33610-292-610	SOCKET ASSY., R. RR. WINKER	1		G
11	33650-304-610	WINKER ASSY., L. RR. 33650-304-611	1	5026200	G
	33650-304-611	WINKER ASSY., L. RR.	1	5026201	G
12	33660-292-610	SOCKET ASSY., L. RR. WINKER	1		G
13	90154-346-610	BOLT, FR. WINKER SETTING	2		G
14	92000-06028-02	BOLT, HEX., 6X28	4	5021590	G
	92000-06025	BOLT, HEX., 6X25	4	5021591	G
15	93500-03010-04	SCREW, PAN, 3X10	8		G
16	93700-03045-08	SCREW, OVAL, 3X45	8	5026200	G
	93700-03048-08	SCREW, OVAL, 3X48	8	5026201	G
17	94001-06000	NUT, HEX., 6MM	4		G
18	94001-10000-05	NUT, HEX., 10MM	2		G
19	94101-06000	WASHER, PLAIN, 6MM	8		G
20	94101-10000	WASHER, PLAIN, 10MM	2		G
21	94111-10200	WASHER, SPRING, 10MM	2		G

8336-36