

J 16

F-14 Rear cushion

F-14 Rear cushion

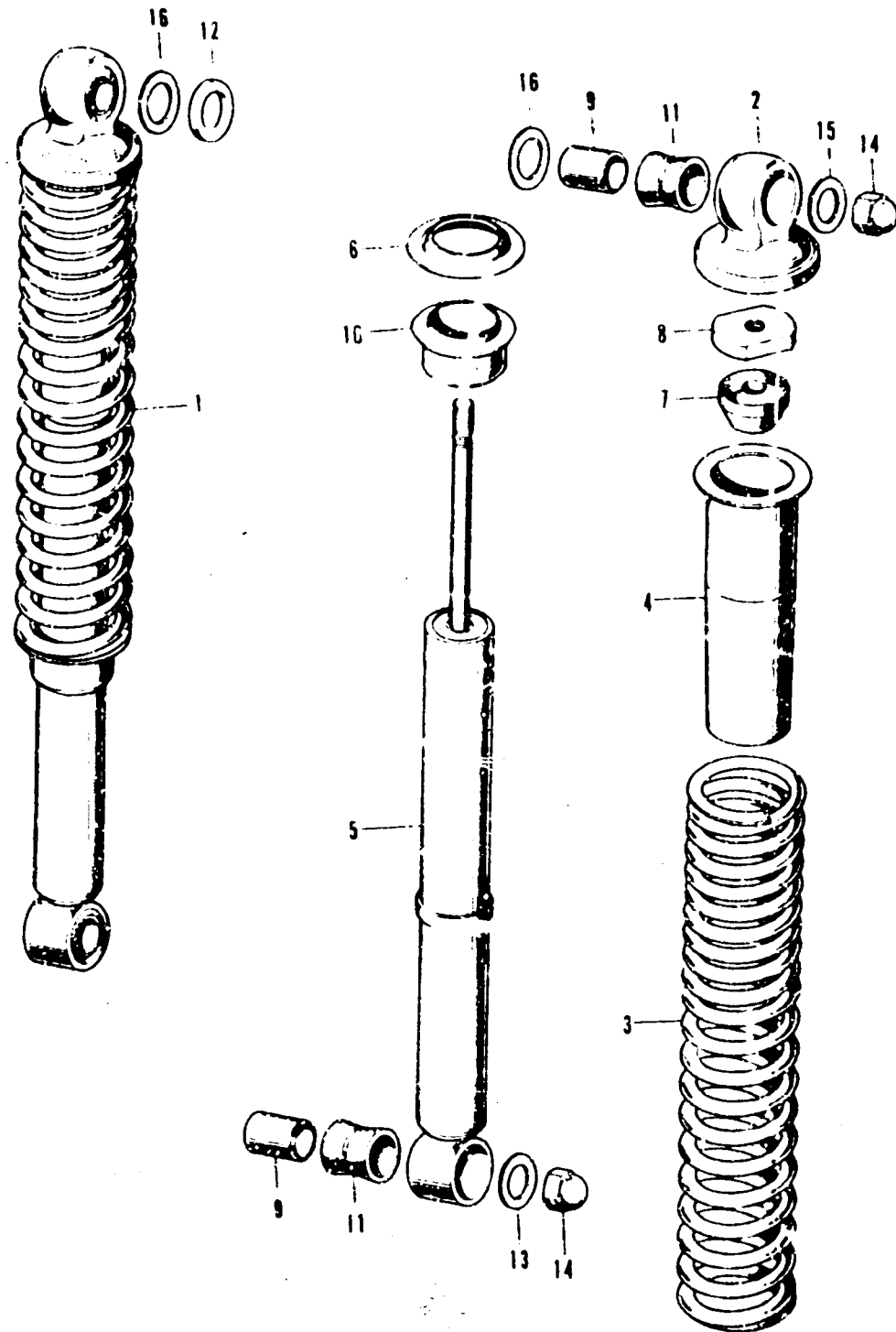

| Ref. No. | Part No. | Description | Ref. No. | | Serial No. |
|----------|----------------|------------------------------------|----------|-----|------------|
| | | | CL. | CL. | |
| 1 | 52401-108-761 | CUSHION ASSY., RR. | 2 | 2 | |
| 2 | 52403-028-000 | METAL, RR. CUSHION UPPER | 2 | 2 | |
| 3 | 52407-103-761 | SPRING, RR. CUSHION | 2 | 2 | |
| 4 | 52409-108-761 | GUIDE, RR. CUSHION SPRING UPPER | 2 | 2 | |
| 5 | 52430-324-003 | DAMPER ASSY., RP. | 2 | 2 | |
| 6 | 52458-108-761 | SEAT, RR. CUSHION SPRING UNDER | 2 | 2 | |
| 7 | 52475-230-010 | RUBBER, RR. CUSHION STOPPER | 2 | 2 | |
| 8 | 52482-056-670 | NUT, RR. CUSHION LOCKING | 2 | 2 | |
| 9 | 52486-056-000 | COLLAR, RR. CUSHION RUBBER BUSH | 4 | 4 | |
| 10 | 52486-303-000 | SEAT, RP. CUSHION SPRING | 2 | 2 | |
| 11 | 52489-056-000 | BUSH, RR. CUSHION UNDER RUBBER | 4 | 4 | |
| 12 | 90526-035-000 | WASHER, 12.2X26 | 1 | 1 | |
| 13 | 90527-230-000 | WASHER, PLAIN, 10.3MM | 2 | 2 | |
| 14 | 94021-10020-05 | NUT, CAP, 10MM | 3 | 3 | |
| 15 | 94101-10000 | WASHER, PLAIN, 10MM | 1 | 1 | |
| 16 | 94101-12000 | WASHER, PLAIN, 12MM | 2 | 2 | |