

Ref. No.	L.O.N.	(Relative ref. Number)	Description	F.R.T.
1	114105		IMPELLER, WATER PUMP .....	0.6
2	114110		MECHANICAL SEAL, WATER PUMP ..	0.9
3		(4)		
	1141B0		COVER, WATER PUMP .....	0.6
5	1141E7		SHAFT, WATER PUMP .....	0.8
6	114142		SPROCKET OR GEAR, WATER PUMP	0.8
		DRIVEN .....		0.8
10	1141D1		OIL SEAL, IMPELLER SHAFT .....	0.9

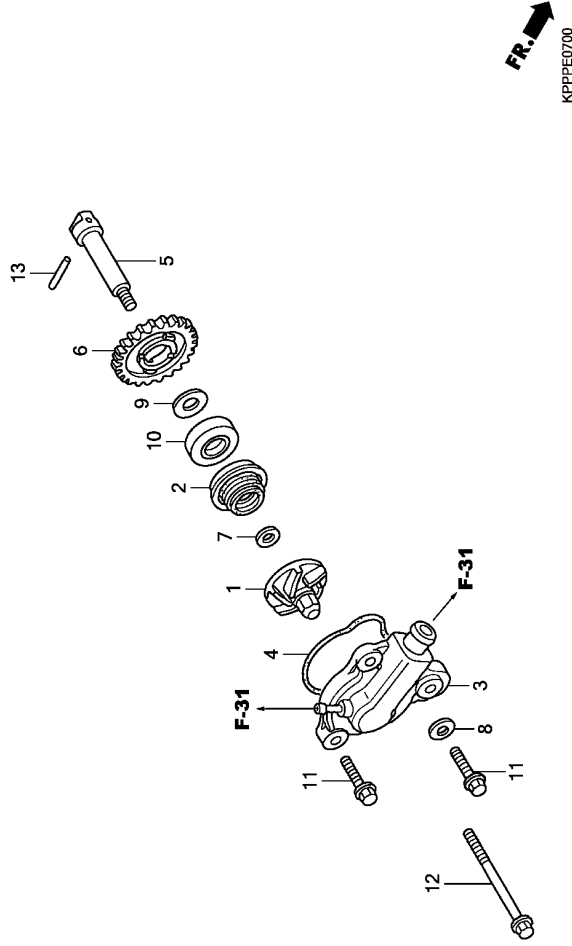

Ref. No.	Part No.	Description	Reqd. QTY					Serial No.	Parts catalogue code
			B	C	D	E	F		
1	19215-KGH-900	IMPELLER, WATER PUMP .....	1	1	1	1	1	1	
2	19217-P72-013	SEAL, MECHANICAL .....	1	1	1	1	1	1	
3	19220-KTY-D30	COVER, WATER PUMP .....	1	1	1	1	1	1	
4	19226-KGH-900	GASKET, WATER PUMP COVER .....	1	1	1	1	1	1	
5	19241-KGH-900	SHAFT, WATER PUMP .....	1	1	1	1	1	1	
6	19242-KPP-T00	GEAR, WATER PUMP DRIVEN(25T)	1	1	1	1	1	1	
7	90423-KW6-900	WASHER, 7X13X1.2 .....	1	1	1	1	1	1	
8	90478-700-000	WASHER A, 6MM .....	1	1	1	1	1	1	
9	90608-072-000	WASHER, 12MM .....	1	1	1	1	1	1	
10	91205-KF0-003	OIL SEAL, 12X20X5 (ARAI) .....	1	1	1	1	1	1	
11	96001-06022-00	BOLT, FLANGE, 6X22 .....	2	2	2	2	2	2	
12	96001-06065-00	BOLT, FLANGE, 6X65 .....	1	1	1	1	1	1	
13	96220-40238	ROLLER, 4X23.8 .....	1	1	1	1	1	1	

