

# F 11

## F-28 Tail Light (Not used in England, Germany & Sweden)

## F-28 Tail Light (Not used in England, Germany & Sweden)

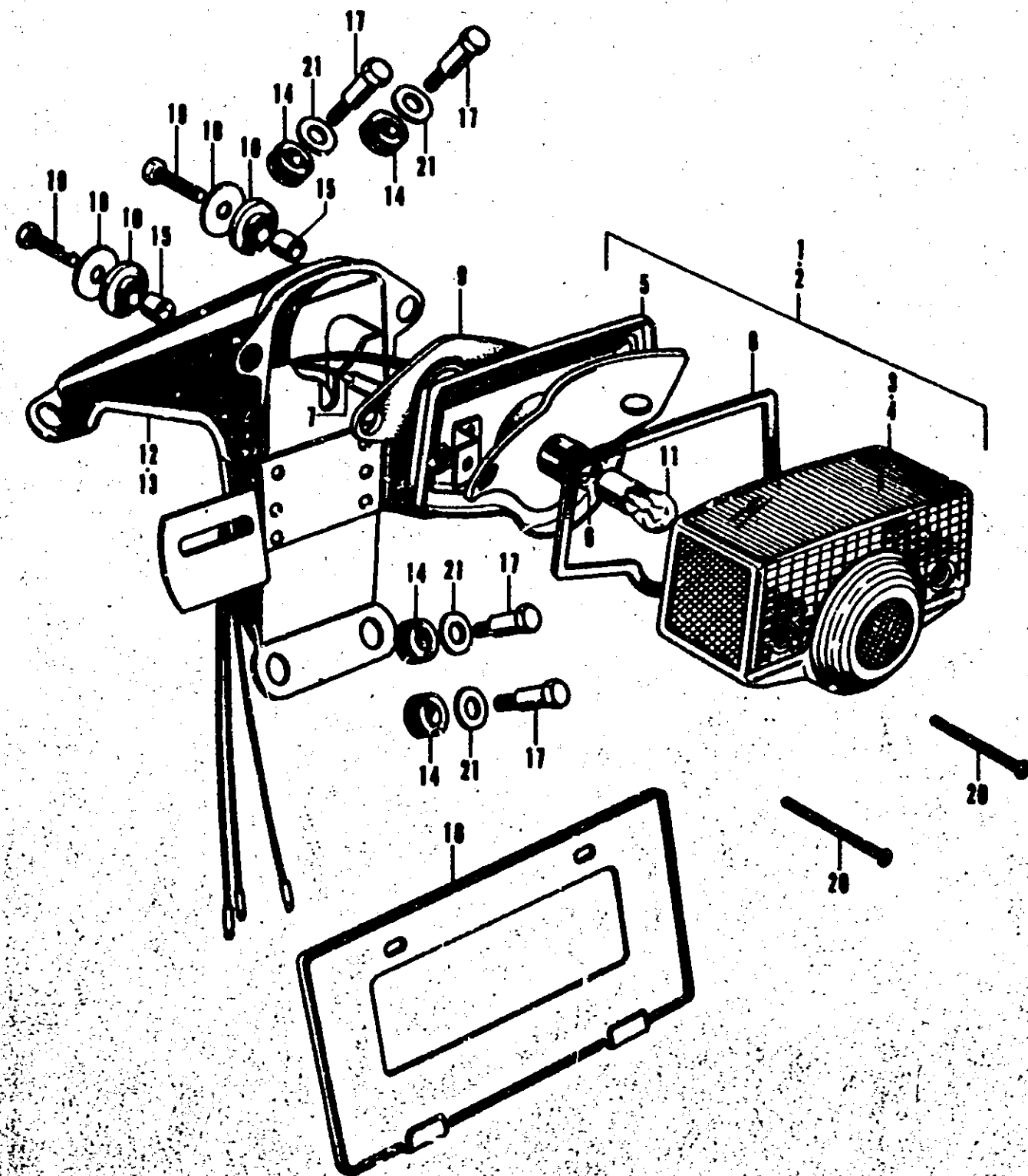

Ref. No.	Part No.	Description	Reqd. No.				Remarks
			250K2	350K2	61	61	
1	33700-235-671	LIGHT ASSY., tail (Used in U.S.A. & France)	1	1	1	1	
2	33700-310-011	LIGHT ASSY., tail	1	1	1	1	
3	33702-077-671	LENS, tail light (Used in U.S.A. & France)	1	1	1	1	
4	33702-303-003	LENS, tail light	1	1	1	1	
5	33703-077-671	BASE COMP., tail light	1	1	1	1	
6	33707-243-670	CORD COMP., tail light	1	1	1	1	
7	33708-243-670	CORD, tail light earth	1	1	1	1	
8	33709-077-671	PACKING, tail light lens	1	1	1	1	
9	33718-077-671	PACKING A, tail light base	1	1	1	1	
10	33719-077-671	PACKING B, tail light base	2	2	2	2	
11	34906-268-810	BULB, tail & stop (12V 23/7W)	1	1	1	1	
12	84701-292-671B	BRACKET, number plate (Black) (Used in U.S.A. & France)	1	1	1	1	
13	84701-317-000B	BRACKET, number plate	1	1	1	1	
14	84706-292-000	RUBBER, number bracket cushion	4	4	4	4	CB250- ~3023783 CL250- ~3004914 CB350- ~2064447 CL350- ~2036301
	80101-283-000	RUBBER, rear fender cushion	4	4	4	4	CB250-3023783 ~ CL250-3004915 ~ CB350-2064448 ~ CL350-2036302 ~
15	84706-286-000	COLLAR, number bracket set	2	2	2	2	
16	84710-300-000	PLATE, number plate back (Not used in U.S.A. & France)	1	1	1	1	
17	90162-292-000	BOLT, front fender setting	4	4	4	4	
18	90521-310-000	WASHER, 20 mm	2	2	2	2	
19	92000-05020-0A	BOLT, hex., 5x20	2	2	2	2	
20	93500-04050-0A	SCREW, pan, 4x50	2	2	2	2	
21	91101-08000	WASHER, plain, 5 mm	4	4	4	4	