

F-34 Frame body

F-34 Frame Body

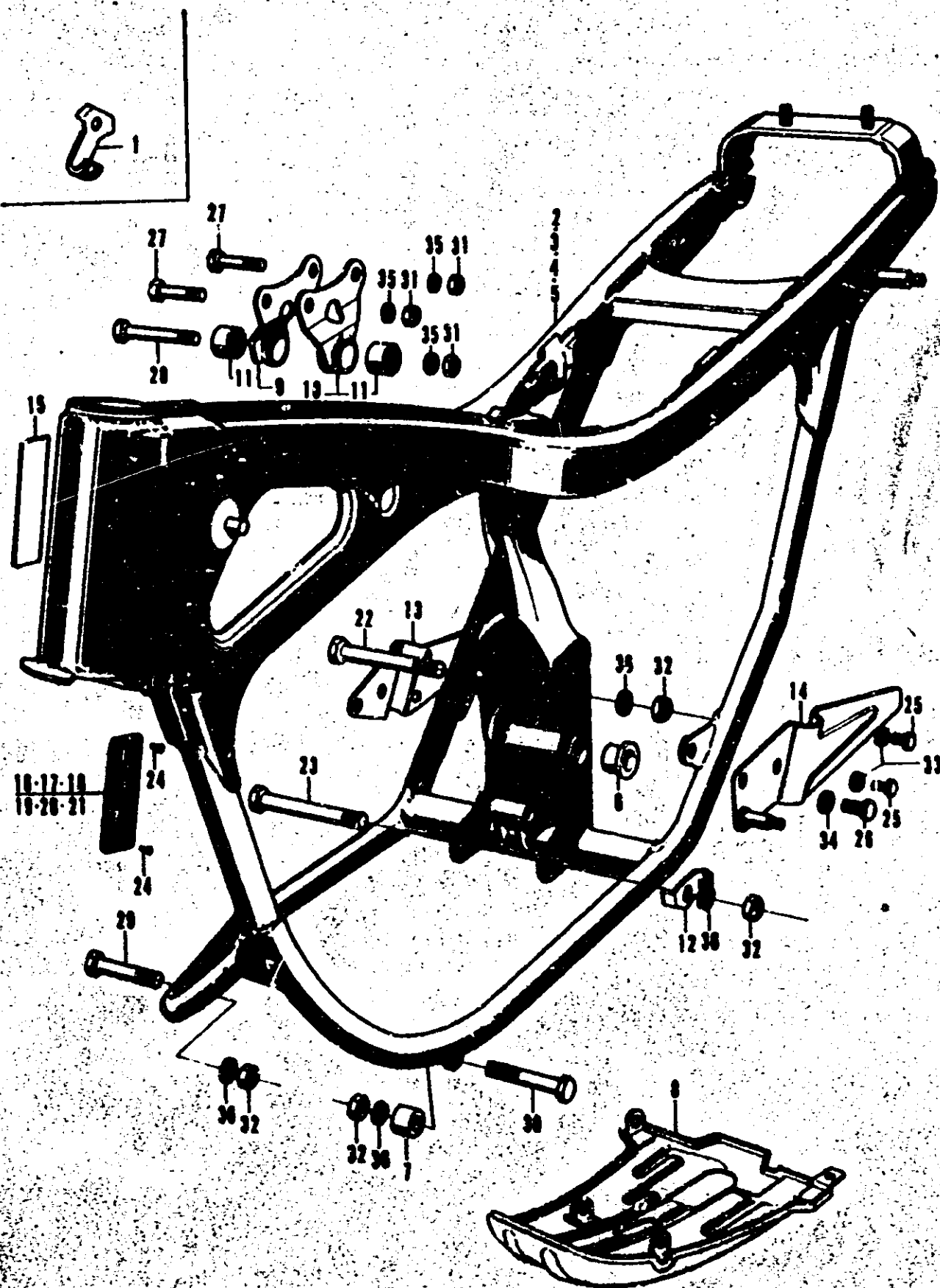

Ref. No.	Part No.	Description	Req'd. No.				Remarks
			25/K3	350K3	01 01 01 01		
21	87501-291-611	PLATE, registered number (Used in Germany)	-	-	-	1	
22	90102-286-000	BOLT A, engine hanger	1	1	1	1	
23	90103-286-000	BOLT B, engine hanger	1	1	1	1	
24	90841-001-000	SCREW, riveting (Used in Germany, France & Sweden)	2	2	2	2	
25	92000-06012	BOLT, hex., 6x12	4	4	4	4	
26	92000-08016-0A	BOLT, hex., 8x16	2	2	2	2	
27	92000-08036-0A	BOLT, hex., 8x36	2	2	2	2	CL250- ~3004979
	92000-08040-0A	BOLT, hex., 8x40	-	2	-	-	CL250-3004980~
28	92000-08085-0A	BOLT, hex., 8x85	1	1	1	1	
29	92200-10050-0A	BOLT, hex., 10x50	1	1	1	1	
30	92200-10063-0A	BOLT, hex., 10x63	1	1	1	1	
31	94001-08000-0S	NUT, hex., 8 mm	3	3	3	3	
32	94001-10000-0S	NUT, hex., 10 mm	4	4	4	4	
33	94101-06000	WASHER, plain, 6 mm	4	4	4	4	
34	94101-08000	WASHER, plain, 8 mm	2	2	2	2	
35	94111-08000	WASHER, spring, 8 mm	3	3	3	3	
36	94111-10000	WASHER, spring, 10 mm	4	4	4	4	