

D 13

E-25 Carburetor (KEIHIN)

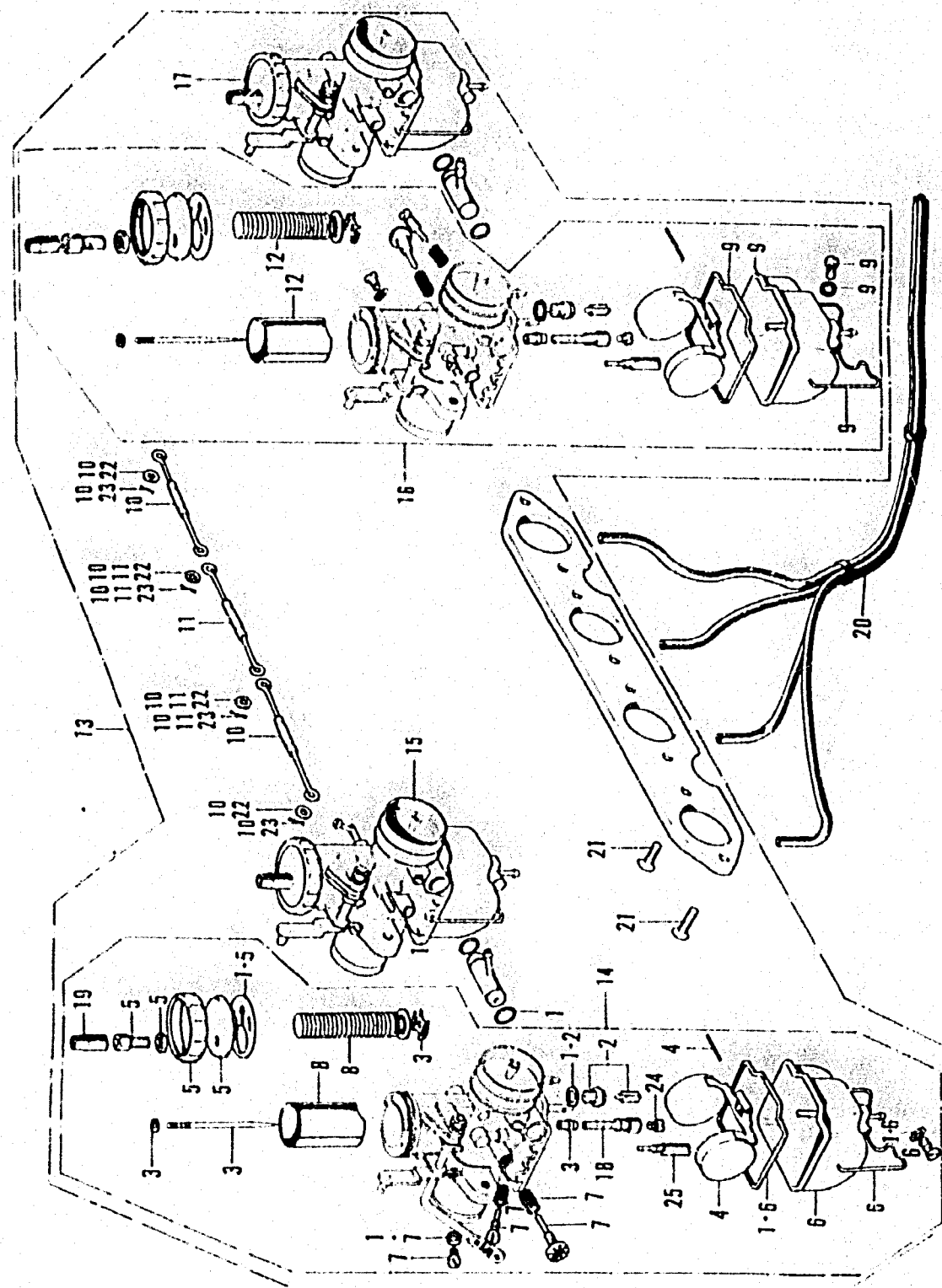

B300-25

E-25 Carburetor (KEIHIN)

Ref. No.	Part No.	Description	Reqd. No.		Serial No.	Area code
			CB	K1 K2		
17	16104-300-014	CARBURETOR ASSY. D	1		1017629	A/E/H/U
	16104-300-610	CARBURETOR ASSY. D	1		1017629	F/G
	16104-300-303	CARBURETOR ASSY. D	1		1017630	1031828 A/E/H/U
	16104-300-313	CARBURETOR ASSY. D	1		1033829	1044812 A/E/H/U
	16104-300-304	CARBURETOR ASSY. U	1		1017630	1044812 F/G
18	16139-300-004	HOLDER, NEEDLE JET	4			
19	16194-300-304	CAP, RUBBER	4			
20	16290-300-000	TUBE, OVER FLOW	1			
21	93600-06016	SCREW, FLAT, 6X16	8			
22	94721-05000	WASHER, PLAIN, 5MM	4			
23	94201-10100	PIN, SPL II, 1.0MM	4			
24	99114-246-1400	JET, MAIN #140	4			
25	99124-300-0400	JET, SLOW #40	4			