

2-D2

F-14-1

Rear wheel
(AR, E, ED, F, FI, G, H, IT, N, SA, SD, SP, SW, U)

Roue arrière
(AR, E, ED, F, FI, G, H, IT, N, SA, SD, SP, SW, U)

Hinterrad
(AR, E, ED, F, FI, G, H, IT, N, SA, SD, SP, SW, U)

Ruede trasera
(AR, E, ED, F, FI, G, H, IT, N, SA, SD, SP, SW, U)

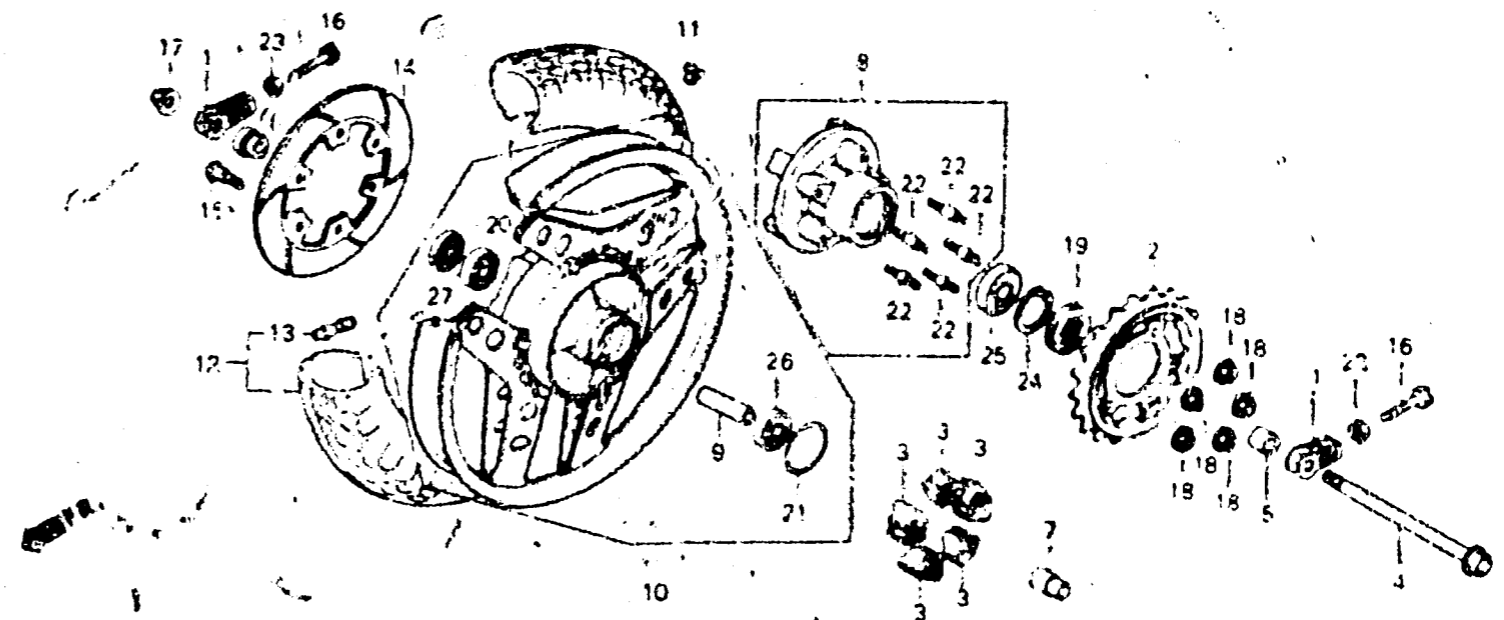

BM86-33

Item d'entretien	T, O, R.	N° de réf.	N° de pièce	Description	N° de série					Code de zone	
		42710-MB6-612		ENS. PNEU AR. (114/50V17 V250 R500 DUNLOP)	1	1	1	1	1	AR E ED F FI G H IT, N SA SD SP SW U
		42710-MJ4-611		ENS. PNEU AR (BSI)	(1)	(1)	(1)	(1)	(1)	AR E ED F FI G H IT, N SA SD SP SW U
		42710-MJ4-612		ENS. PNEU AR (DUNLOP)	(1)	(1)	(1)	(1)	(1)	AR E ED F FI G H IT, N SA SD SP SW U
		42710-MB6-633		ENS. PNEU AR (METZ) (140/50 V517 PERFECT ME99A2)	-	(1)	(1)	(1)	(1)	AR E ED F FI G H IT SD SP SW U
	13	42753-425-003		VALVE DE JANTE (BSI)	1	1	1	1	1	AR E ED F FI G H IT, N SA SD SP SW U
		42753-425-004		VALVE DE JANTE (DUNLOP)	1	1	1	1	1	AR E ED F FI G H IT, N SA SD SP SW U
		42753-MJ7-004		VALVE DE JANTE (DUNLOP)	-	(1)	(1)	(1)	(1)	AR E ED F FI G H IT SD SP SW U
	14	4335-MJ0-000		DISQUE DE FREIN AR	1	1	1	1	1	AR E ED F FI G H IT, N SA SD SP SW U
	15	90105-M50-010		BOUTON DE DISQUE AR 6X33	6	6	6	6	6	AR E ED F FI G H IT, N SA SD SP SW U