

ASSEMBLY

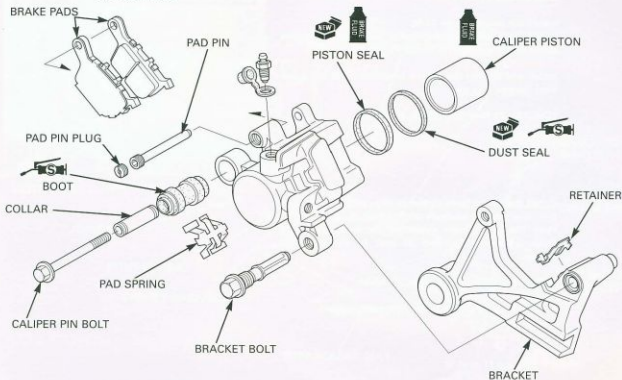

Coat the new piston seal with clean brake fluid.
Coat the new dust seal with silicone grease.

Install the piston seal and dust seal into the groove of the caliper body.

Coat the caliper piston with clean brake fluid and install it into the caliper cylinder with its opening end toward the pad.

If the caliper and bracket pin boots are hard or deteriorated, replace them with new ones.
Apply silicone grease to the inside of the bracket pin boot.

Install the bracket pin boot and collar into the caliper.

Install the pad retainer into the bracket.

Apply silicone grease to the caliper pin and install the caliper body to the bracket.

Install the pad spring into the caliper bracket.

Install the caliper bracket bolt and brake pads (page 15-8).

