

Exhaust System Removal/Installation

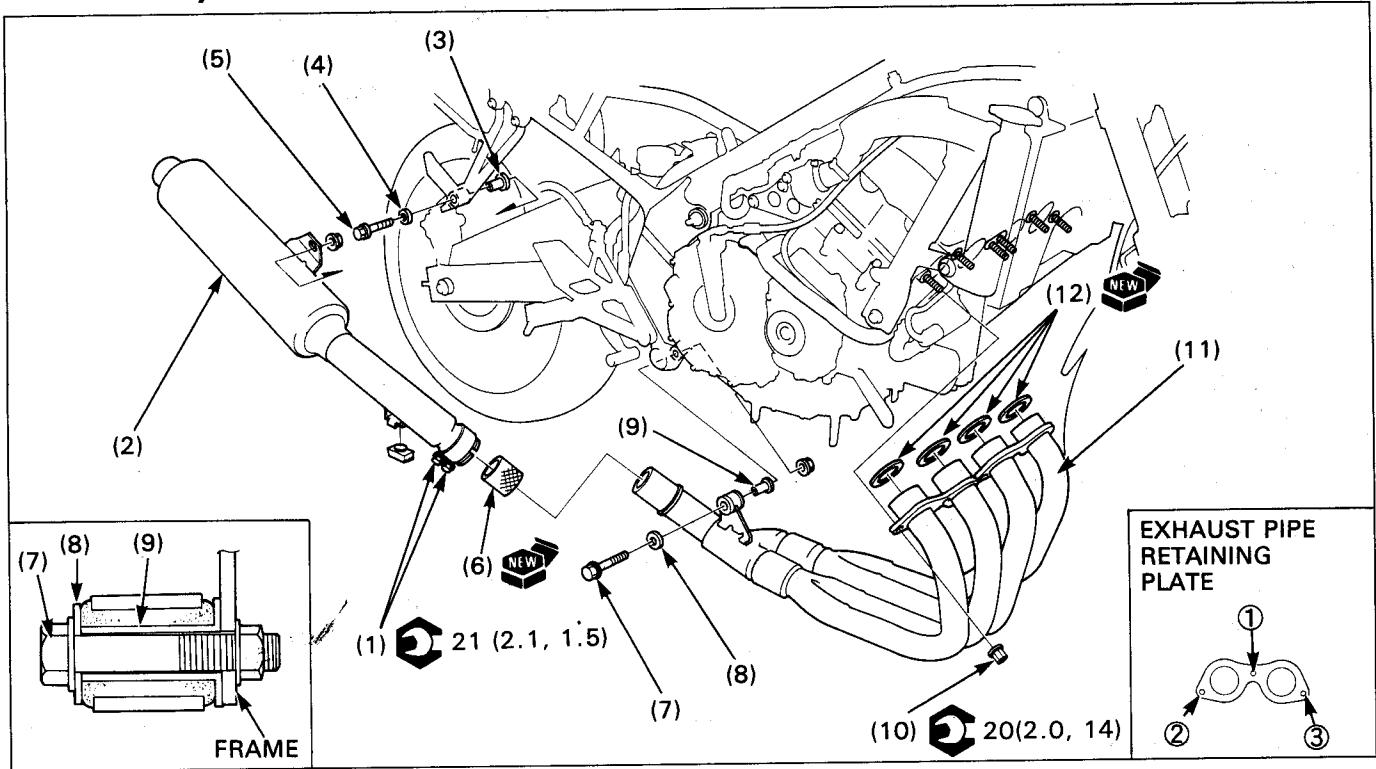

⚠ WARNING

- Do not service the exhaust system while it is hot.

Requisite Service

- Side fairing removal/installation (page 2-3)

Procedure	Q'ty	Remarks
Removal Order		Installation is in the reverse order of removal. Only loosen.
(1) Muffler band bolt	2	
(2) Muffler mounting bolt	1	
(3) Flange collar	1	
(4) Washer	1	
(5) Muffler	1	
(6) Muffler gasket	1	
(7) Exhaust pipe mounting bolt	1	
(8) Washer	1	
(9) Flange collar	1	NOTE • Install the flange collar with the flange side facing the frame
(10) Exhaust pipe	6	NOTE • Tighten the joint nuts in the order as shown.
(11) Exhaust pipe	1	
(12) Exhaust pipe gasket	4	