

Right Handlebar Removal /Installation

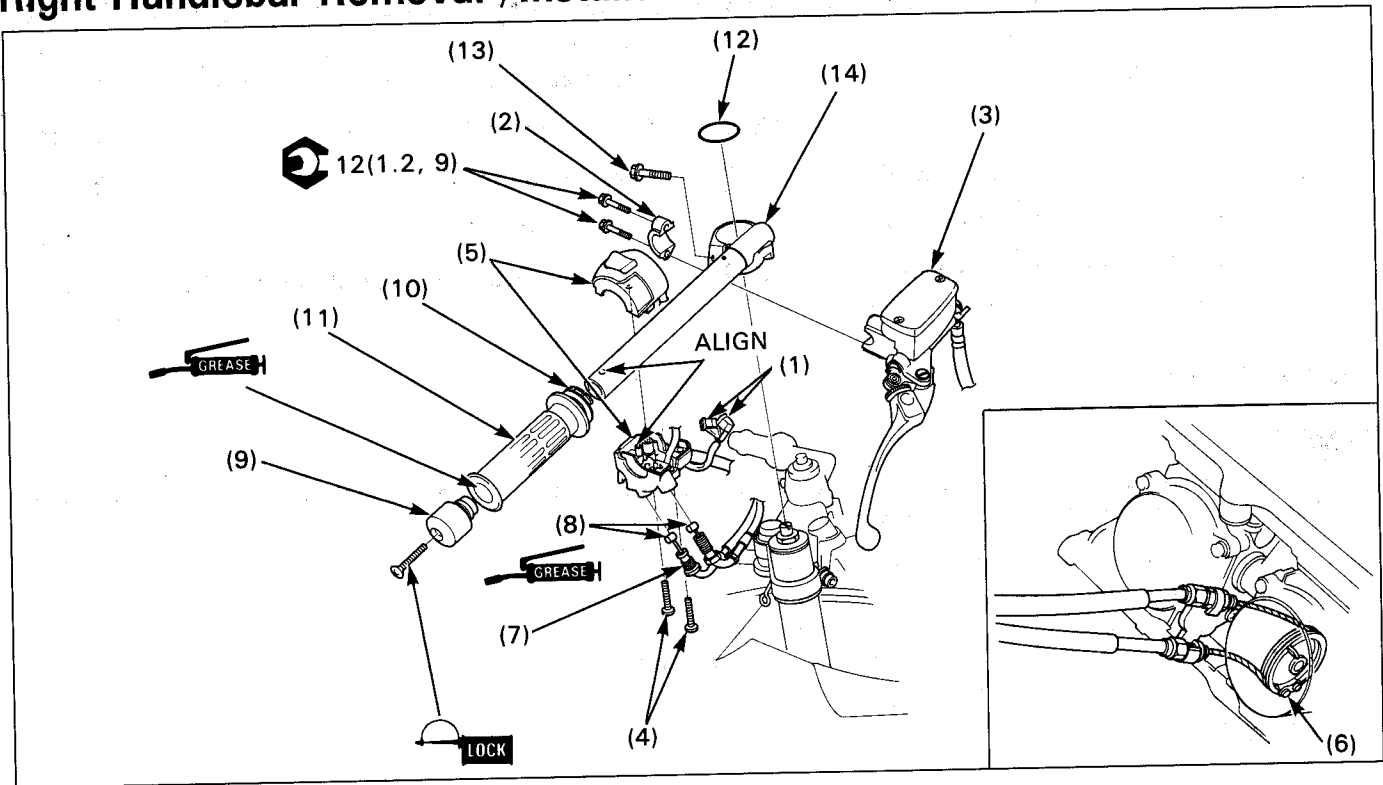

WARNING

• Contaminants in the system may cause a reduction or loss of braking ability.

CAUTION

• Spilled brake fluid will damage painted, plastic or rubber parts.

Requisite Service

- Air cleaner case removal/installation (page 6-3)
- Throttle grip free play adjustment (Refer to section 2 of the Common Service Manual.)

Procedure	Q'ty	Remarks
Removal Order		Installation is in the reverse order of removal.
(1) Front brakelight switch connector	2	
(2) Master cylinder holder	1	Align the holder mating surface with the punch mark on the handlebar and install the holder with the "UP" mark upward.
(3) Master cylinder assembly	1	
(4) Right handlebar switch housing screw	2	Tighten the front screw first then the rear one.
(5) Right handlebar switch housing	1	Align the tang of the housing with the hole in the handlebar.
(6) Throttle cable end (carburetor side)	1	
(7) Throttle cable nut	1	
(8) Throttle cable end (throttle pipe side)	2	Don't bend the cables too much.
(9) Handlebar weight	1	Align its boss with the inner weight.
(10) Throttle pipe	1	
(11) Throttle grip	1	Apply Honda Bond A or an equivalent to the inside surface of the grip.
(12) Stopper ring	1	
(13) Handlebar pinch bolt	1	Tighten the pinch bolt while pushing the handlebar forward.
(14) Right handlebar	1	Align the handlebar boss with the top bridge slot.