

# Left Handlebar Removal/Installation

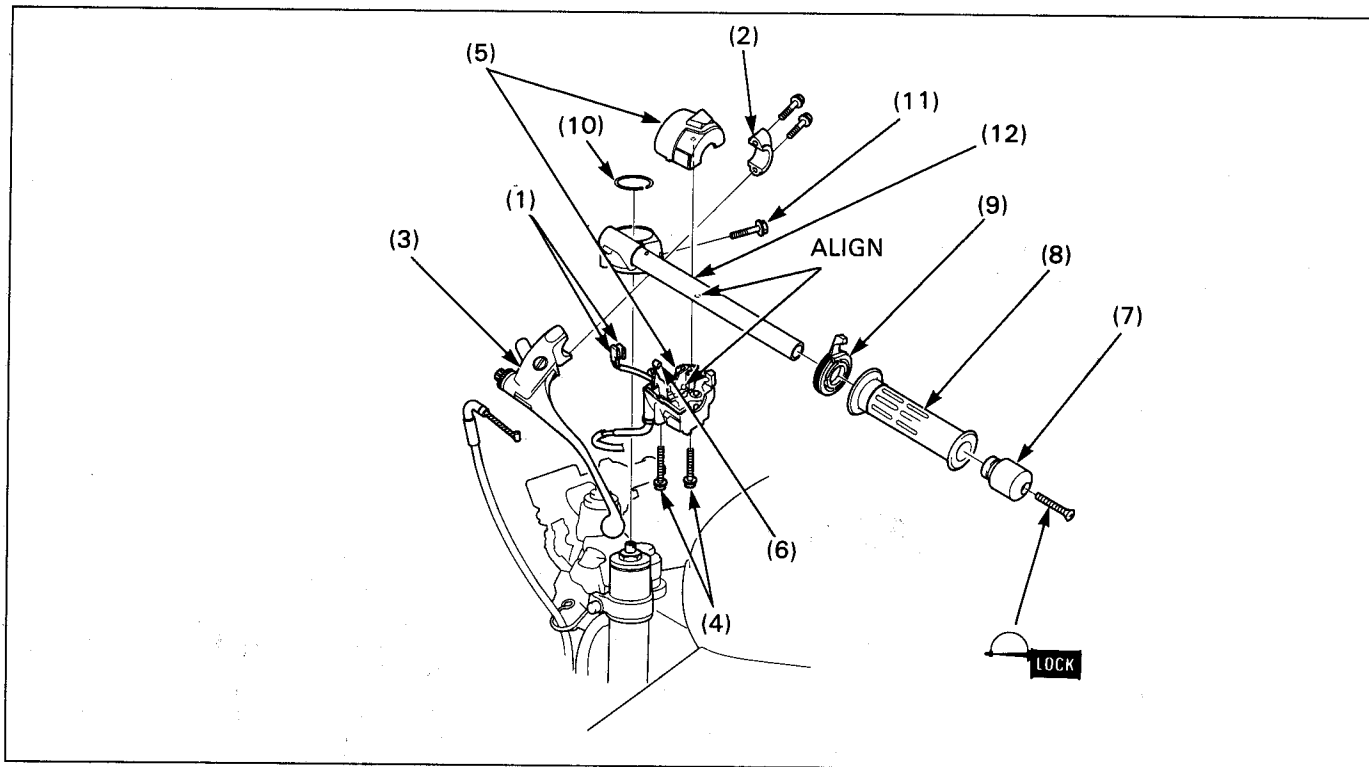

**CAUTION**

• Spilled brake fluid will damage painted, plastic or rubber parts.

Procedure	Q'ty	Remarks
<b>Removal Order</b>		Installation is in the reverse order of removal.
(1) Clutch switch connector	2	
(2) Clutch lever holder	1	Align the holder mating surface with the punch mark on the handlebar and face the holder with the "UP" mark upward. Tighten the upper bolt first then the lower bolt.
(3) Clutch lever assembly	1	
(4) Left handlebar switch housing screw	2	Tighten the front screw first then the rear one.
(5) Left handlebar switch housing	1	Align the boss of the housing with the hole in the handlebar.
(6) Choke cable	1	
(7) Handlebar weight	1	Align its boss with the inner weight.
(8) Handle grip	1	Apply Honda Bond A or an equivalent to the inside surface of the grip.
(9) Choke lever	1	
(10) Stopper ring	1	
(11) Handlebar pinch bolt	1	Tighten the pinch bolt while pushing the handlebar forward.
(12) Left handlebar	1	Align the handlebar boss with the top bridge slot.