

# Rear Wheel Removal/Installation

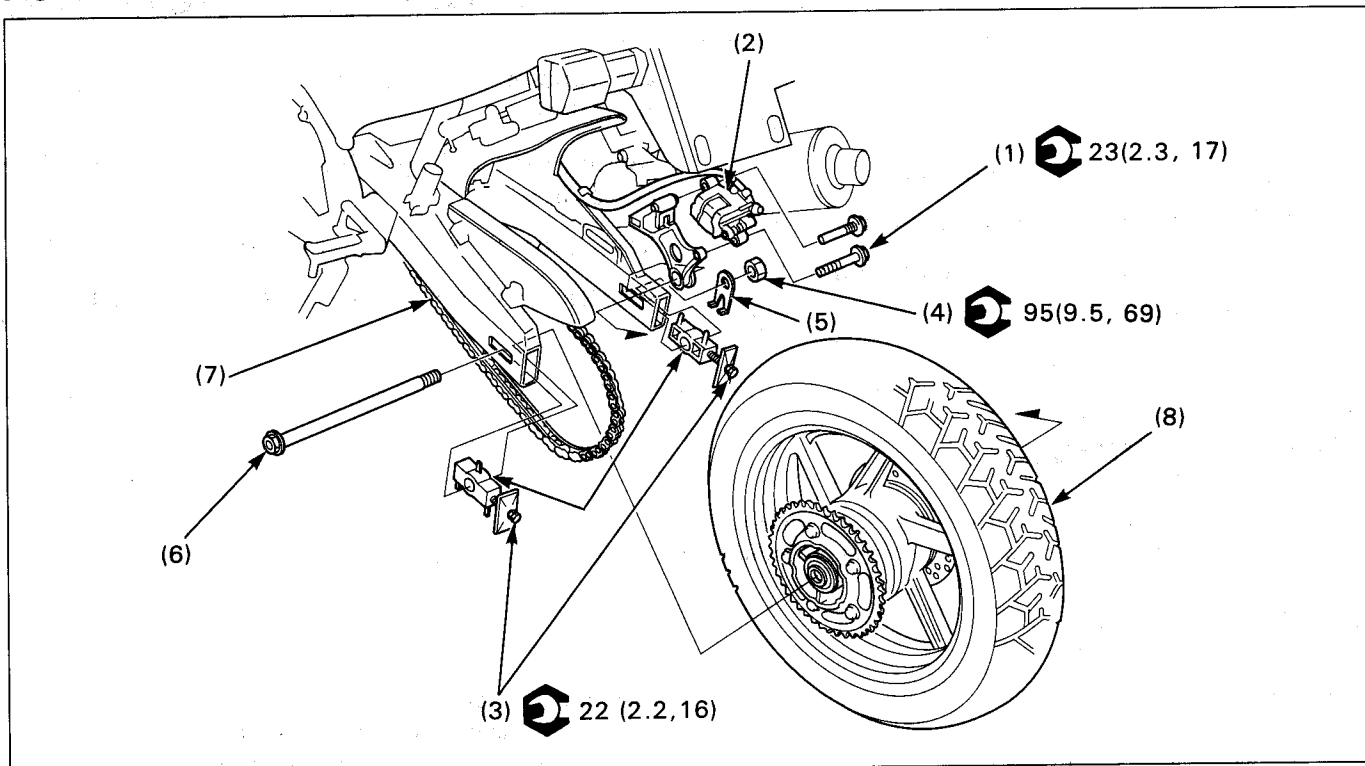

**⚠ WARNING**

- A contaminated brake disc or pad reduces stopping power. Discard contaminated pads and clean a contaminated disc with a high quality brake degreasing agent.

**CAUTION**

- Do not suspend the brake caliper from the brake hose. Do not twist the brake hose.

**NOTE**

- Put the motorcycle on its center stand.
- Do not depress the brake pedal when the caliper is removed, or it will be difficult to refit the disc between the brake hose.
- Adjust the drive chain slack after installing the wheel.

Procedure	Q'ty	Remarks
<b>Removal Order</b>		Installation is in the reverse order of removal.
(1) Rear caliper bracket bolt	1	
(2) Rear brake caliper assembly	1	Release the brake hose from the clamp on the rear fender B and pivot the brake caliper upward.
(3) Lock nut/Drive chain adjusting nut	2/2	Loosen them all the way and push the wheel forward all the way.
(4) Rear axle nut	1	
(5) Washer	1	
(6) Rear axle shaft	1	
(7) Drive chain	1	
(8) Rear wheel assembly	1	
(9) Drive chain adjuster	1	Install the drive chain adjusters with the graduated side facing out.