

Combination Meter Bulb Replacement

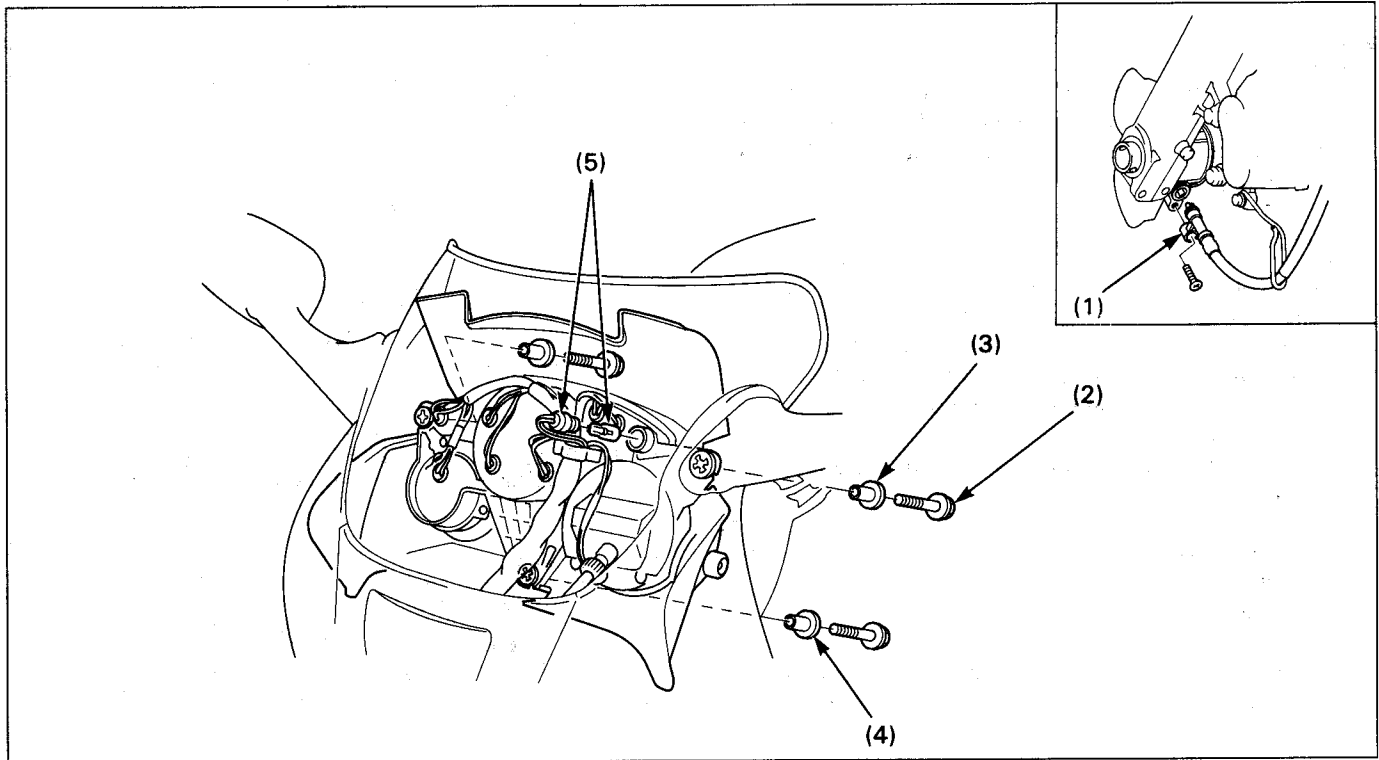

Procedure	Q'ty	Remarks
Removal Order		Installation is in the reverse order of removal.
(1) Speedometer cable	1	Disconnect the cable at the speedometer gear box.
(2) Meter mounting bolt	3	Raise the combination meter and pull over the rubber cover so that you can remove the bulb socket.
(3) Collar (short)	2	
(4) Collar (long)	1	
(5) Bulb socket/Bulb	11/11	