

BRAKE PEDAL

REMOVAL

Pull the brake arm pin holder forward, and disconnect the brake rod from the brake arm.

Pull the brake pedal return spring and unhook it from the swing arm.

Unhook the brake light switch spring.

Pull out the brake pedal pivot bolt lock pin.
Remove the pivot bolt and brake pedal.

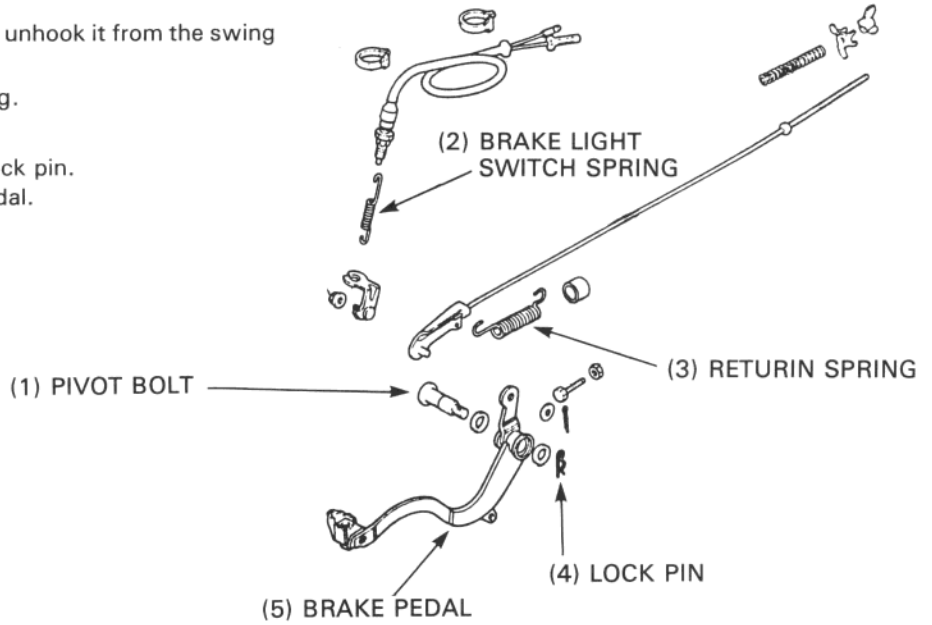

INSTALLATION

Install the dust seals into the brake pedal.
Apply grease to the brake pedal pivot hole and dust seals.

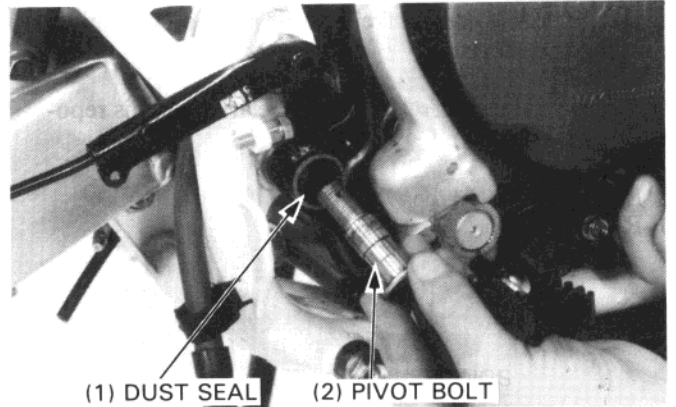

Install the pivot bolt, then set the lock pin.
Hook the return spring to the swingarms spring hook and brake light switch spring.

Set the brake arm pin holder to the brake arm.

